

# STABLING CATALOGUE

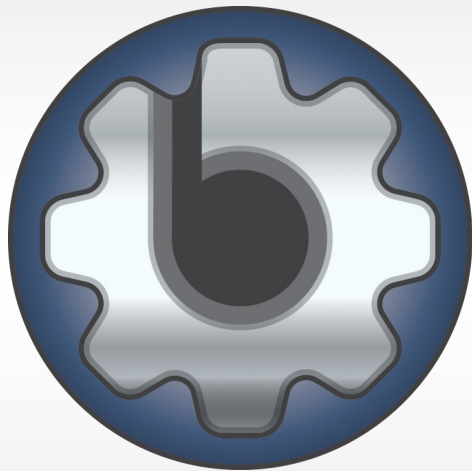

**BAUMAN**  
**MANUFACTURING**  
BACKED BY A TRADITION OF QUALITY

**3 INDUSTRIAL DRIVE, ELMIRA, ON**

P: 1.866.813.4448

F: 1.800.572.6796

E: [sales@baumanmfg.com](mailto:sales@baumanmfg.com)

[www.baumanmfg.com](http://www.baumanmfg.com)

2/15/2019

# OUR STORY



For over 40 years Bauman Manufacturing has served the Waterloo Region. Many things have changed and some have stayed the same. Over the years, while our products have improved through ongoing research and development, we have maintained a focus on serving you-our customers– and offering uncompromised product quality.

Bauman Manufacturing began in the early 1970's distributing and manufacturing replacement chain in Conestoga, Ontario. In 1974, custom stabling became a viable aspect of the company's product line and continues to be an important product for Bauman's to this day. In 1990, the Ebersol line of inclined elevators and conveyors was added. In 1991, the purchase of Conestoga Chain increased Bauman's market share and opened up the industrial supply market. Bauman imports chains and parts to supply OEMs through vendor managed inventory programs and in 2016, became the Canadian distributor for Binacchi PTOs.

To better serve customers in a newer and more accessible location, Bauman Manufacturing relocated to a new facility in Elmira in 2001. As always, Bauman continues to offer its customers diversified product lines and custom manufacturing where your product is made to your specifications.

Bauman's company philosophy is to strive each day to continuously improve and offer the best in quality and service. Building relationships between employees, customers and suppliers enables Bauman Manufacturing to continue to promote teamwork since Bauman believes that, after all, people are our most valuable asset.

# STABLING



## Contents

TERMS .....	4
FREE STALLS .....	5-9
SMALL ANIMAL FREE STALL .....	5
HEIFER FREE STALL.....	6
LARGE ANIMAL FREE STALL .....	7
LARGE ANIMAL FREE STALL– SAND BEDDING .....	8
FREE STALL ACCESSORIES.....	9
CHANNEL POST TIE STALL.....	10-11
CHANNEL POST TIE STALL COMPONENTS.....	11
GATES .....	12-25
2 BAR GATES .....	14-15
3 BAR GATES.....	16-17
4 BAR GATES.....	18-19
5 BAR GATES.....	20-21
GATE POSTS .....	22
GATE MOUNTING ACCESSORIES.....	22
GATE LATCHES .....	23
GATE ORDER FORM .....	24-25
SLANT BAR.....	26-29
CALF .....	26
YOUNG STOCK.....	27
HEIFER .....	27
LARGE ANIMAL.....	28
LARGE HEAD OPENING.....	29
MANGER FRONTS.....	30-35
CALF SELF-LOCK—ADJUSTABLE OPENING.....	30
HEIFER SELF-LOCK—ADJUSTABLE OPENING .....	31
LARGE CATTLE 24” SELF-LOCK ADJUSTABLE.....	32
LARGE CATTLE 24” SELF-LOCK NON-ADJUSTABLE .....	32
LARGE CATTLE 28” SELF-LOCK.....	33
LARGE CATTLE 28” SELF-LOCK NON-ADJUSTABLE .....	33
SELF-LOCK PARTS COMMON TO ALL SIZES.....	34
MANGER RAIL AND ACCESSORIES.....	35
CALF PENS.....	36-39
PLASTIC PEN FRONTS AND PARTITIANS .....	36
SPINDLE PEN FRONTS AND PARTITIANS.....	37
CALF PEN POSTS.....	38
CALF PEN ACCESSORIES.....	39



# STABLING

## **Terms:**

Payment can be made by: Cheque, Cash, VISA, Mastercard or Debit.

All sales are Net 30 days on approved accounts. Pricing is FOB Bauman Mfg., Elmira, Ontario.

Prices & Information are subject to change without notice.

Minimum invoice is \$25.00. Applicable taxes are extra.

## **Service Charges:**

A service charge will be added to overdue accounts. Accounts with balances or accounts over 60 days may be placed on hold.

## **Warranty:**

90 days on replacement parts, 1 year on new equipment.

## **Returns:**

NO ITEM MAY BE RETURNED UNLESS AUTHORIZED BY BAUMAN MFG.

Non stock, custom items may not be returned for credit.

Product must be in good condition, not used and ready for resale.

A restocking charge may apply.

# STABLING



## SMALL ANIMAL FREE STALL

Free stall size typically ideal for young animals from ages 3-10 months.

### TYPE A

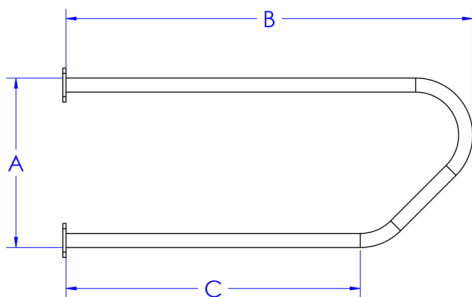

### TYPE B

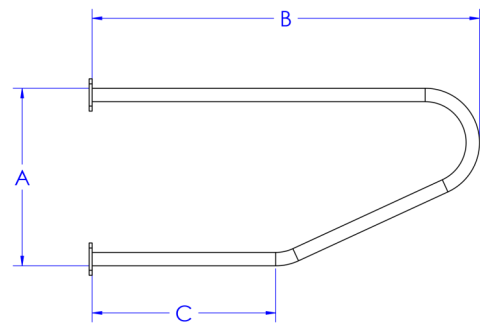

SMALL ANIMAL FREE STALL				
PART #	DIMENSIONS			TYPE A or B
	A	B	C	
02611 166 20 x 48	20"	48"	34 3/4"	A
02611 166 22 x 48	22"	48"	22 3/4"	B
02611 166 22 x 60	22"	60"	50 1/2"	B
02611 190 28 x 60	28"	60"	35"	B
02611 190 28 x 70	28"	70"	40"	B

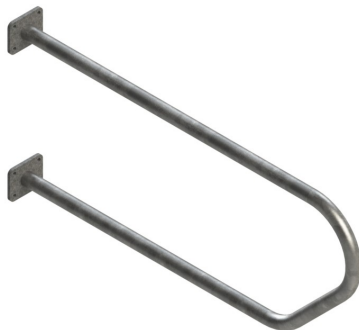

When ordering free stalls, it needs to be stated what size of post the stall loop will be mounted to. This determines the size of the mounting plate to be welded on.

Custom sizes of Free Stalls are available .

Call for information and pricing.

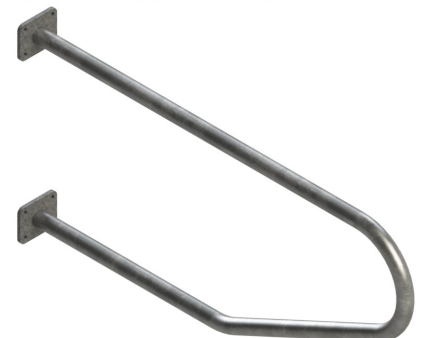

All free stalls are comprised of a formed tube with mounting plates (3/8" thick) welded to the tube ends as depicted. All weldments receive a hot-dip galvanizing finish for added corrosive resistance.

Tube size is indicated by the second integer of the product code, for example 02611 166 20 x 48.

166 = 1.66" O.D. x .140" wall thickness

### 02002 104 FREE STALL HEADRAIL

Stock 1 1/4" galvanized pipe, 21 feet long. Often used in conjunction with crossover clamps and the top portion of free stall dividers. Cut to desired length upon installation.

## HEIFER FREE STALL

Free stall size typically ideal for cattle from ages 11-22 months.

### TYPE C

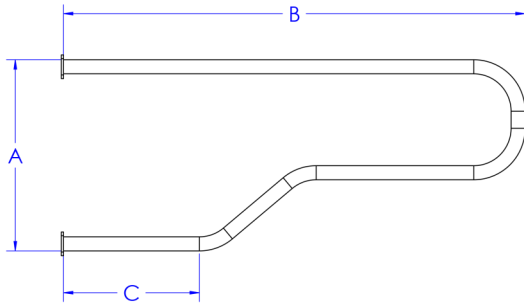

### TYPE D

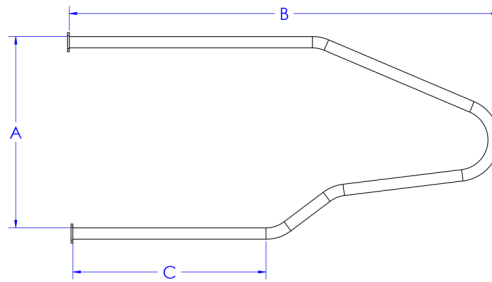

HEIFER FREE STALL				
PART #	DIMENSIONS			TYPE A, B, C, D or E
	A	B	C	
02611 206 32 x 60	32"	60"	20 1/2"	C
02611 206 32 x 70	32"	70"	19"	D
02611 206 32 x 78	32"	78"	23"	C
02611 190 32 x 70	32"	70"	40"	B
02611 190 32 x 80	32"	80"	50"	B

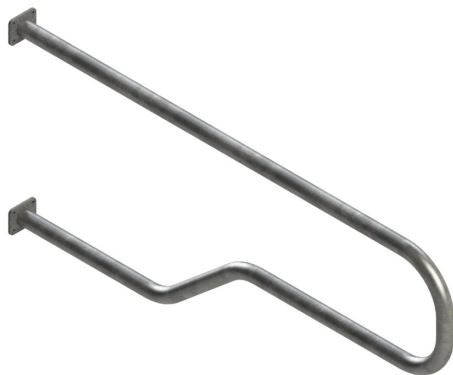

When ordering free stalls, it needs to be stated what size of post the stall loop will be mounted to. This determines the size of the mounting plate to be welded on.

Custom sizes of Free Stalls are available .

Call for information and pricing.

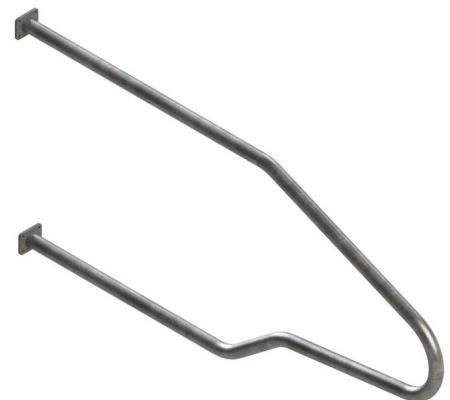

Tube size is indicated by the second integer of the product code, for example 02611 206 32 x 60.

190 = 1.90" O.D. x .125" wall thickness

206 = 2 3/8" O.D. x .125" wall thickness

# STABLING



## LARGE ANIMAL FREE STALL

Free stall size typically ideal for cows from ages 22 months to adult.

### TYPE E

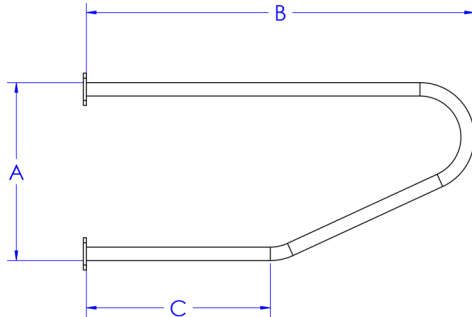

### TYPE F

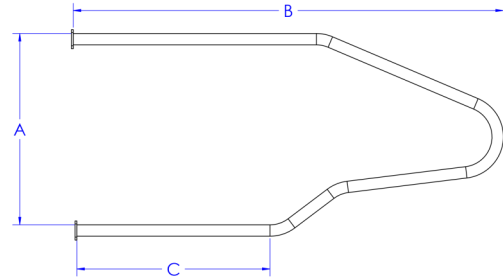

LARGE ANIMAL FREE STALL				
PART #	DIMENSIONS			TYPE A, B, C, D or E
	A	B	C	
02611 206 40 x 73	40"	73"	22 1/2"	F
02611 206 40 x 76	40"	76"	23"	E
02611 206 40 x 78	40"	78"	25"	E
02611 206 40 x 80	40"	80"	29 1/2"	F
02611 206 40 x 84	40"	84"	32"	E
02611 206 40 x 86	40"	86"	35 1/2"	F
02611 206 40 x 90	40"	90"	40 1/2"	F
02611 206 40 x 96	40"	96"	45 1/2"	F

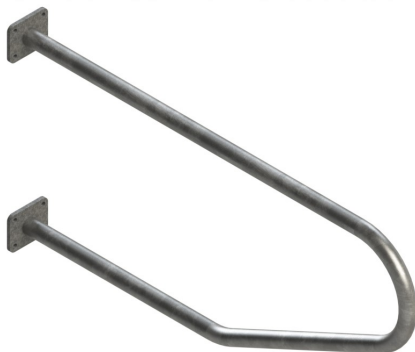

When ordering free stalls, it needs to be stated what size of post the stall loop will be mounted to. This determines the size of the mounting plate to be welded on.

Custom sizes of Free Stalls are available .

Call for information and pricing.

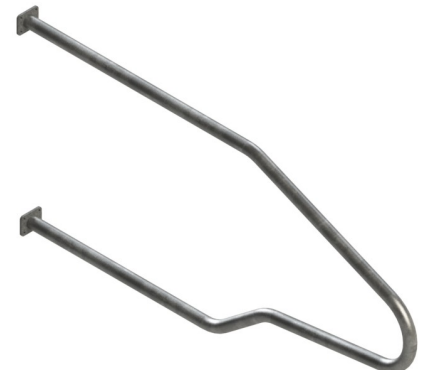

## LARGE ANIMAL FREE STALL-SAND BEDDING

### TYPE G

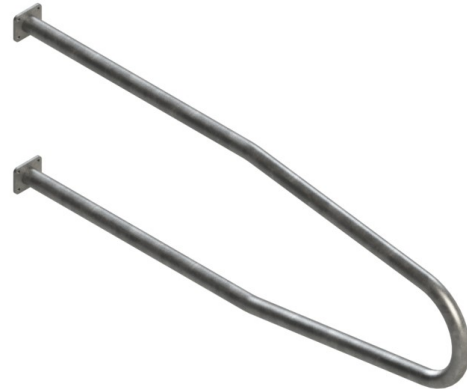
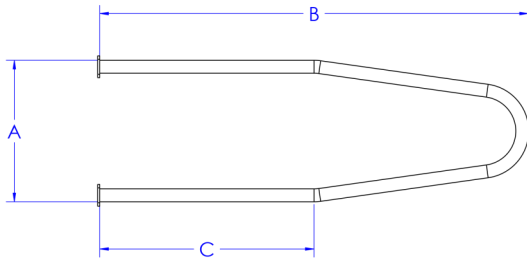

LARGE ANIMAL FREE STALL—SAND BEDDING				
PART #	DIMENSIONS			TYPE A, B, C, D or E
	A	B	C	
02611 206 26 x 79	26"	79"	39 1/2"	G
02611 206 30 x 84	30"	84"	46"	G
02611 206 38 x 78	38"	78"	40"	G
02611 206 30 x 96	30"	96"	52"	G

These stalls are designed for adult cattle, but have a narrower profile ideal for sand-bedding settings. The bottom tube rests higher off the ground than the standard version, which reduces the contact with corrosive elements more prominently present with sand-bedding.

## FREE STALL POSTS

The items listed in this section are intended to be used for mounting the free stalls. Typically these items are tubes with a clinched end to be set in the ground then cemented in place. They can also be supplied with a plate on one end for lagging to a curb, then cemented in.

FREE STALL POSTS	
PART #	DESCRIPTION
02611 013	Free Stall Post Galvanized 2.375 O.D. x .188 Wall x 60"
02611 013-63	Free Stall Post Galvanized 2.875 O.D. x .203 Wall x 63"
02611 013-66	Free Stall Post Galvanized 2.375 O.D. x .188 Wall x 66"



# STABLING



## FREE STALL ACCESSORIES

**02611 016** (for 1 1/4" Galvanized Pipe)  
**02611 018** (for 2" Galvanized Pipe)

### Wall Brackets

Brackets consist of a tube welded to a plate which can be bolted or welded in place.

The wall bracket tube goes inside the long tube.

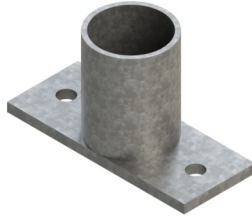

**02611 015** (for 1 1/4" Galvanized Pipe)  
**02611 017** (for 2" Galvanized Pipe)

### Pipe Joiners

6" joiners co-axially link two of the same size tubes together.

The joiner is positioned inside the coupled tubes.



**02611 019**

### Brisket Bar Brackets

A brisket bar allows you to control how close a cow can lay to the front of a stall.

To install a brisket bar, mount a brisket bar bracket to each lower tube in a series of free stall dividers (using U-bolts). A long tube (the brisket bar) or wooden planks are then aligned with the other face of these brackets and installed via U-bolts or bolts. The location of the brackets can then be slid to the desired offset, then tightened in place.

This bracket fits tubes up to 3" O.D. U-bolts are not included.



### Crossover "U" Bolt Clamps

Perpendicularly links two tubes together. Tubes in isometric view are for reference only. Clamp assemblies consist of a plate with slotted holes and four U-bolts sized respectively.



PART #	DESCRIPTION
02611 025	1-1/4" x 1-1/4" Pipe Crossover Clamp
02611 021	2" x 1-1/4" Pipe Crossover Clamp
02611 012	2" x 2" Pipe Crossover Clamp
02611 024	2" x 3" Pipe Crossover Clamp
02611 027	1-1/2" x 1-1/2" Pipe Crossover Clamp
02611 028	1-1/4" x 1-1/2" Pipe Crossover Clamp
02611 029	1-1/2" x 2" Pipe Crossover Clamp
02611 030	2" x 2-1/2" Pipe Crossover Clamp
02611 032	1-1/2" x 2-1/2" Pipe Crossover Clamp (Also fits 1-1/4" x 2 1/2" Pipe)
02611 034	1-1/4" x 3" Pipe Crossover Clamp (Also fits 1-1/2" x 3" Pipe)

### "U" Bolts

Standard U-Bolts Sold with Nuts.

PART #	DESCRIPTION
02611 009	2-3/8" x 3 1/4" U-bolt Fits Over 2" Pipe (2-3/8 O.D.)- w/nuts
02611 020	1-11/16" x 2-1/2" U-bolt Fits Over 1-1/4" Pipe (1-5/8 O.D.)- w/nuts
02611 022	2" x 2-3/4" U-bolt Fits Over 1-1/2" Pipe (1.90 O.D.)- w/nuts
02611 023	3-1/2" x 4-1/2" U-bolt Fits Over 3" Pipe (3-1/2" O.D.)- w/nuts
02611 026	3" x 3-7/8" U-bolt Fits Over 2 7/8" & 3" O.D. Tube
02611 040	1/2" Rod 3" x 6" U-bolt Fits Over 2 7/8 x 3" O.D. Post -w/nuts*
02611 050-SS	7/16" U-bolt - Stainless Steel Rod 4" x 5 1/4" Fits Over 4" O.D. Tube with Regular Flange Nut*
02611 052-SQ-SS	7/16" U-bolt - Stainless Steel Rod 6" x 6 3/4" fits 6" x 6" Square Tube with Regular Flange Nut*



\*SPECIAL ORDER

## CHANNEL POST TIE STALL



- 02618 3630** - 36" x 30" Assembly
- 02618 4226** - 48" x 30" Assembly
- 02618 4230** - 42" x 30" Assembly
- 02618 4830** - 42" x 26" Assembly
- 02618 6600** - Channel Post, Passage Way Divider, Headrail Support Arm: Nuts & Bolts \*not shown

**Tie Stall Assembly Packages** - The packages include the mounting post, tie stall divider, headrail support arm, and all the necessary hardware to mount the components to the post. Though depicted in the image, the milk-line support brackets are **not** included with these packages.

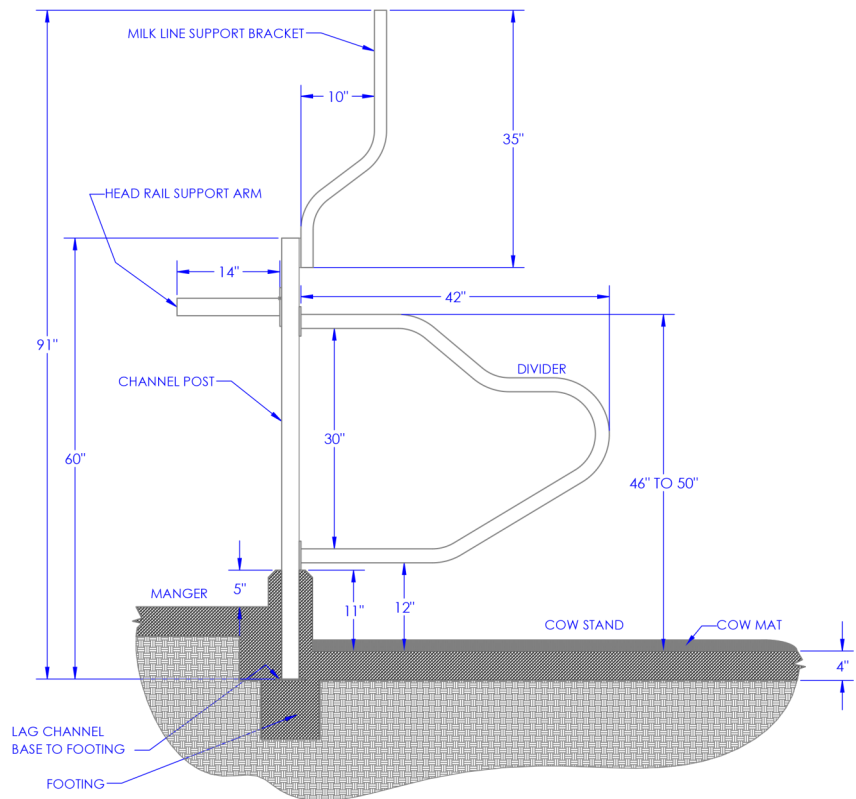

### 02618 100

#### Tie Stall Posts

These posts stand 60" tall and consist of a sheet metal plate formed into a channel, with shorter plates capping the top and bottom ends. The channel has an array of holes for mounting the divider at variable heights.

These posts are commonly bolted to a footer and then cemented in place.



#### Tie Stall - Dividers Only

- 02618 135** - 36" x 30" Channel Post Tie Stall Divider
- 02618 140** - 48" x 30" Channel Post Tie Stall Divider
- 02618 150** - 42" x 30" Channel Post Tie Stall Divider
- 02618 160** - 42" x 26" Channel Post Tie Stall Divider

# STABLING



## CHANNEL POST TIE STALL COMPONENTS



**02613 004**

**Neck Chain**

42" long neck chain with ring and quick link.



**02613 002-36**

**Neck Chain**

36" long tie chain with snap fitting. Connects to neck chain (0213 004).



**02618 170**

**Divider Passageway**

Dividers for a passageway are to be mounted to the outer channel post (02618 100) in a series. They act as a wall at the end of the row.



**02618 120**

**Head Rail Support Arm**

14 1/4" long connects to tie stall post (02618 100) and is used to mount the headrail which is also water line.

Hardware is not included.

**02618 130-10**

**Milk-line Support Brackets**

These brackets come in two standard sizes, and can be secured to the channel tie stall posts. They provide mounting supports for vacuum and milk-line.



**02618 130-18**



**02614 003 HRE** (for 1 1/4" pipe)

**02614 004 HRE** (for 2" pipe)

**Tie Chain Clamp**

These brackets are typically installed onto water line headrail, and hold the neck chains (02613 002-36) in place.

**Hardware is included.**



**102125U**

**Single Bolt Crossover Clamp**

These clamps are used to fasten water line headrail to the support arm (02618 120).



## GATES

This section includes multi-purpose gates of various lengths and heights. The taller the gate, the greater the number of lateral tubes. The longer the gate, the greater the number of vertical support tubes. Gates are mounted using two adjustable hinges (02506 ADJUST THREADED ROD HINGE) which are included with the gate.

In general gates are custom made to customer requirements/dimensions, but for pricing purposes gate costs have been listed in 6" intervals. When placing an order for a full gate assembly:

- Specify the desired length and height of the gate
- Indicate whether the hinge bracket will be bolted, or welded in place
- Choose a latch based on how your gate will latch

### Multi-bar Hinge Brackets

#### Bolt-on

These brackets are typically used to mount the Multi-bar Gates. They are available in various sizes to match the variety of gate heights.

This particular style is intended to be bolted in place, ideally to a flat surface.

Extended versions (EXTEN) are available for offset hinge positions.

#### Weld-on

These brackets are typically used to mount the Multi-bar Gates. They are available in various sizes to match the variety of gate heights.

This particular style is intended to be welded in place. For added weldment strength, the triangular mounting shape allows for two contact regions, and easier mounting on round posts.

Extended versions (EXTEN) are available for offset hinge positions.

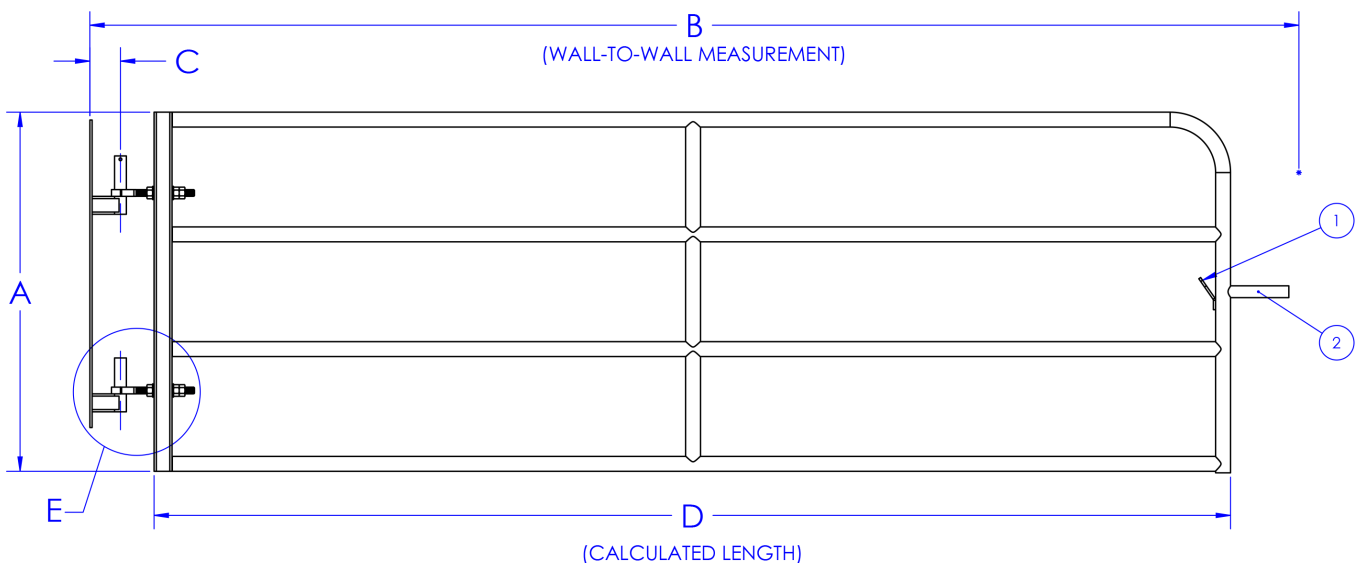

# STABLING

## GATES

### Adjustable Threaded Rod Hinge Brackets

Two of these components are included with each multi-bar gate frame. The nut locations can be adjusted to provide additional variability to the gate length (self leveling).

The hole in hinge plate fits around the posts of multi-bar hinge brackets, as pictured below.

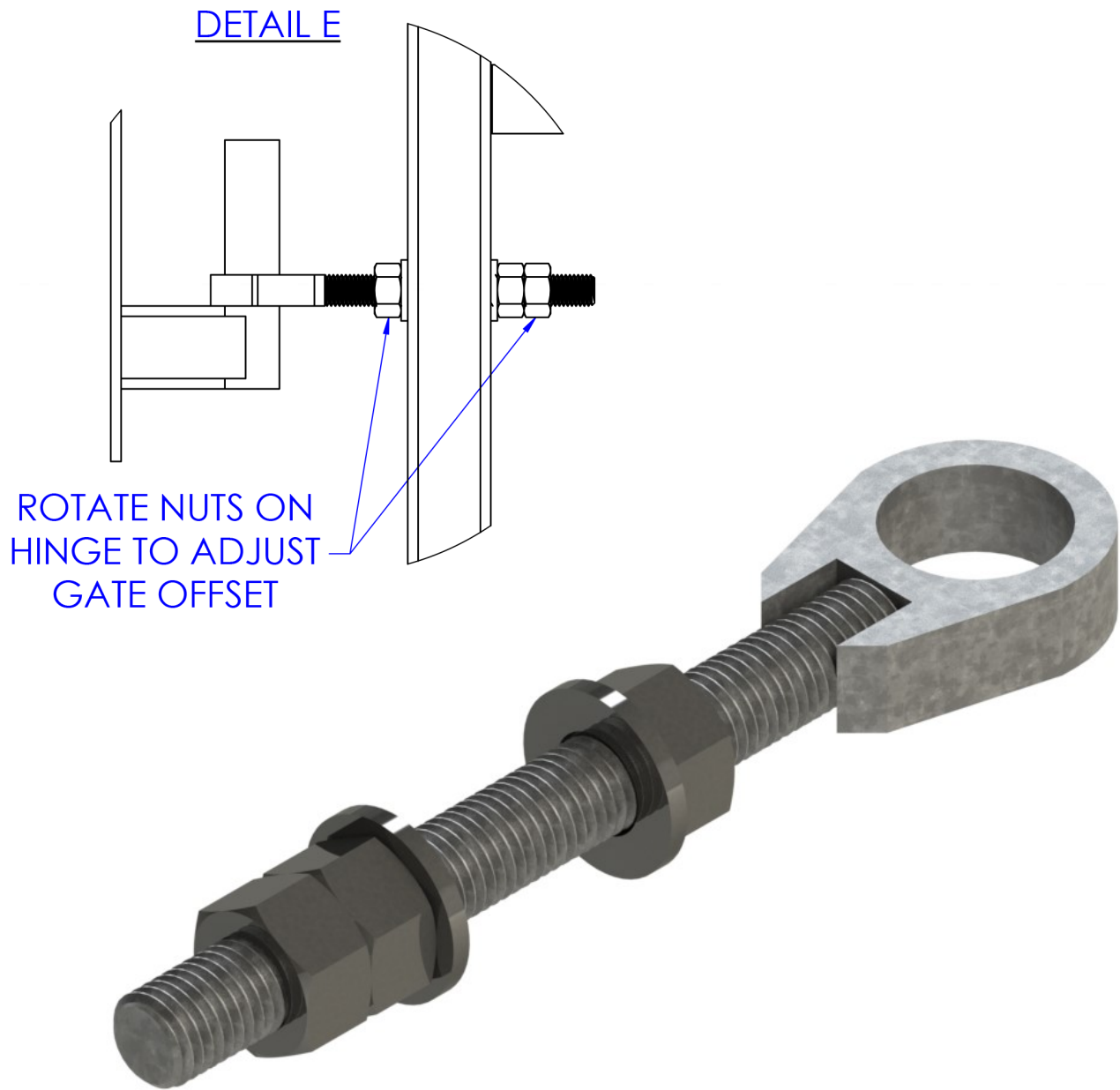

## GATES - 2 BAR

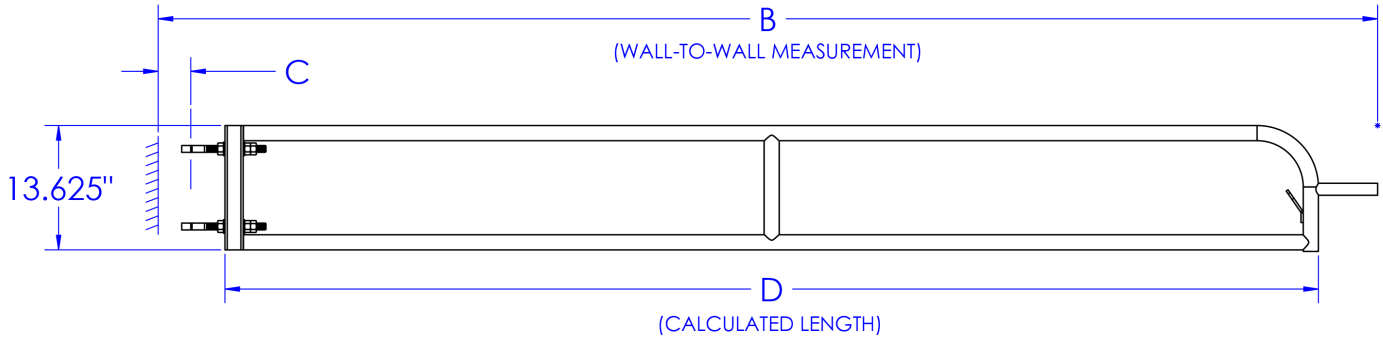

2 BAR HINGE BRACKETS				
PART #	DESCRIPTION	DIMENSIONS		
		C	F	G
53031 062	Hinge Bracket Weld-on	2.25	13.5	3
02500 2BG HB	Hinge Bracket Bolt-on	1.4375	17	3.75

**53031 062**

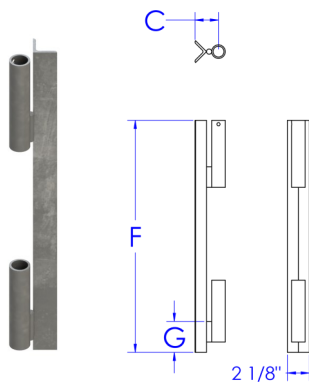

**02500 2BG HB**

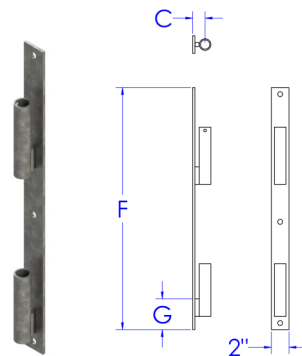

# STABLING



## GATES - 2 BAR

<b>NO UPRIGHT CENTER POST</b>			
<b>LENGTH</b>	<b>PART #</b>	<b>A</b>	<b>B</b>
3'	02506 2BG 030	13.625	36
3'6"	02506 2BG 036	13.625	42
4'	02506 2BG 040	13.625	48
4'6"	02506 2BG 046	13.625	54
5'	02506 2BG 050	13.625	60
5'6"	02506 2BG 056	13.625	66
<b>1 UPRIGHT CENTER POST</b>			
6'	02506 2BG 060	13.625	72
6'6"	02506 2BG 066	13.625	78
7'	02506 2BG 070	13.625	84
7'6"	02506 2BG 076	13.625	90
8'	02506 2BG 080	13.625	96
8'6"	02506 2BG 086	13.625	102
9'	02506 2BG 090	13.625	108
9'6"	02506 2BG 096	13.625	114
10'	02506 2BG 100	13.625	120
10'6"	02506 2BG 106	13.625	126
11'	02506 2BG 110	13.625	132
11'6"	02506 2BG 116	13.625	138
12'	02506 2BG 120	13.625	144
12'6"	02506 2BG 126	13.625	150
13'	02506 2BG 130	13.625	156
13'6"	02506 2BG 136	13.625	162
14'	02506 2BG 140	13.625	168
14'6"	02506 2BG 146	13.625	174
<b>2 UPRIGHT CENTER POSTS</b>			
15'	02506 2BG 150	13.625	180
15'6"	02506 2BG 156	13.625	186
16'	02506 2BG 160	13.625	192
16'6"	02506 2BG 166	13.625	198

## GATES - 3 BAR

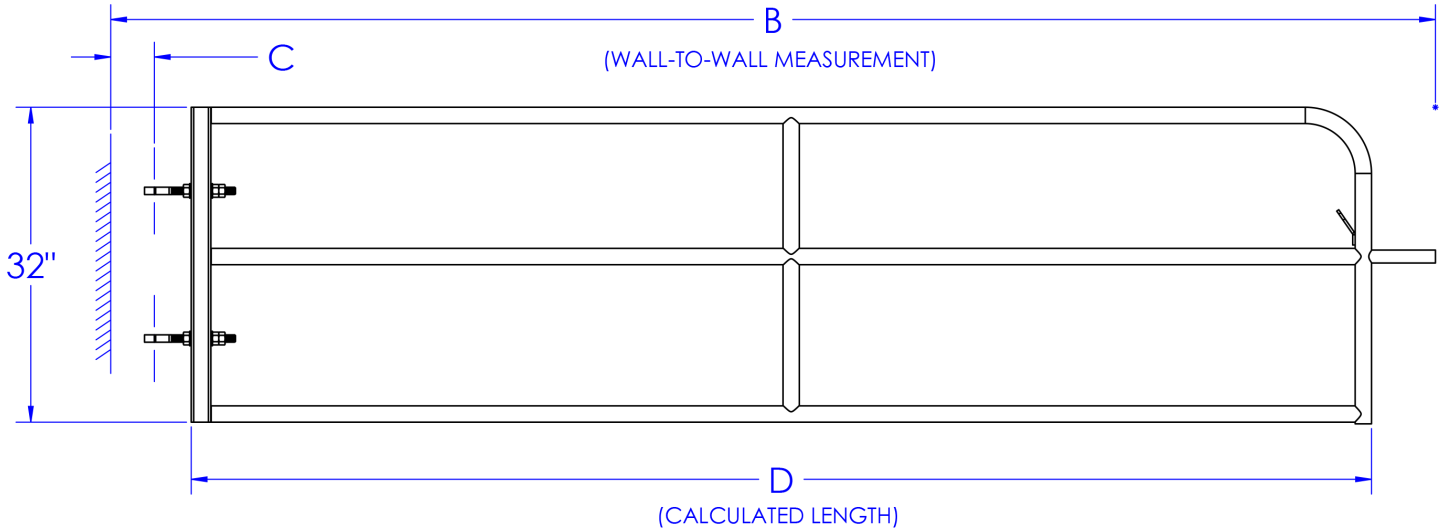

3 BAR HINGE BRACKETS				
PART #	DESCRIPTION	DIMENSIONS		
		C	F	G
53031 075	Hinge Bracket Weld-on	2.25	22.5	3
53031 075 EXTEN	Hinge Bracket Extended Weld-on	4.25	22.5	3
02500 3BG HB 3200	Hinge Bracket Bolt-on	1.4375	27.5	3.5
02500 3BG HB 3200 EXTEN	Hinge Bracket Extended Bolt-on	3.4375	27.5	3.5

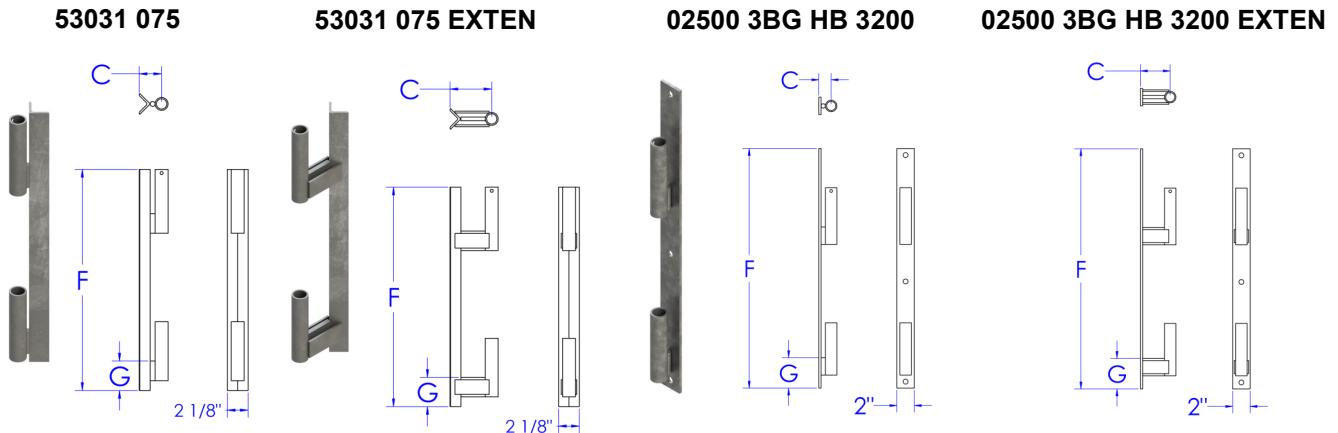



# STABLING



## GATES - 3 BAR

<b>NO UPRIGHT CENTER POST</b>			
<b>LENGTH</b>	<b>PART #</b>	<b>A</b>	<b>B</b>
3'	02506 3BG 030	32	36
3'6"	02506 3BG 036	32	42
4'	02506 3BG 040	32	48
4'6"	02506 3BG 046	32	54
5'	02506 3BG 050	32	60
5'6"	02506 3BG 056	32	66
<b>1 UPRIGHT CENTER POST</b>			
6'	02506 3BG 060	32	72
6'6"	02506 3BG 066	32	78
7'	02506 3BG 070	32	84
7'6"	02506 3BG 076	32	90
8'	02506 3BG 080	32	96
8'6"	02506 3BG 086	32	102
9'	02506 3BG 090	32	108
9'6"	02506 3BG 096	32	114
10'	02506 3BG 100	32	120
10'6"	02506 3BG 106	32	126
11'	02506 3BG 110	32	132
11'6"	02506 3BG 116	32	138
12'	02506 3BG 120	32	144
12'6"	02506 3BG 126	32	150
13'	02506 3BG 130	32	156
13'6"	02506 3BG 136	32	162
14'	02506 3BG 140	32	168
14'6"	02506 3BG 146	32	174
<b>2 UPRIGHT CENTER POSTS</b>			
15'	02506 3BG 150	32	180
15'6"	02506 3BG 156	32	186
16'	02506 3BG 160	32	192
16'6"	02506 3BG 166	32	198

## GATES - 4 BAR

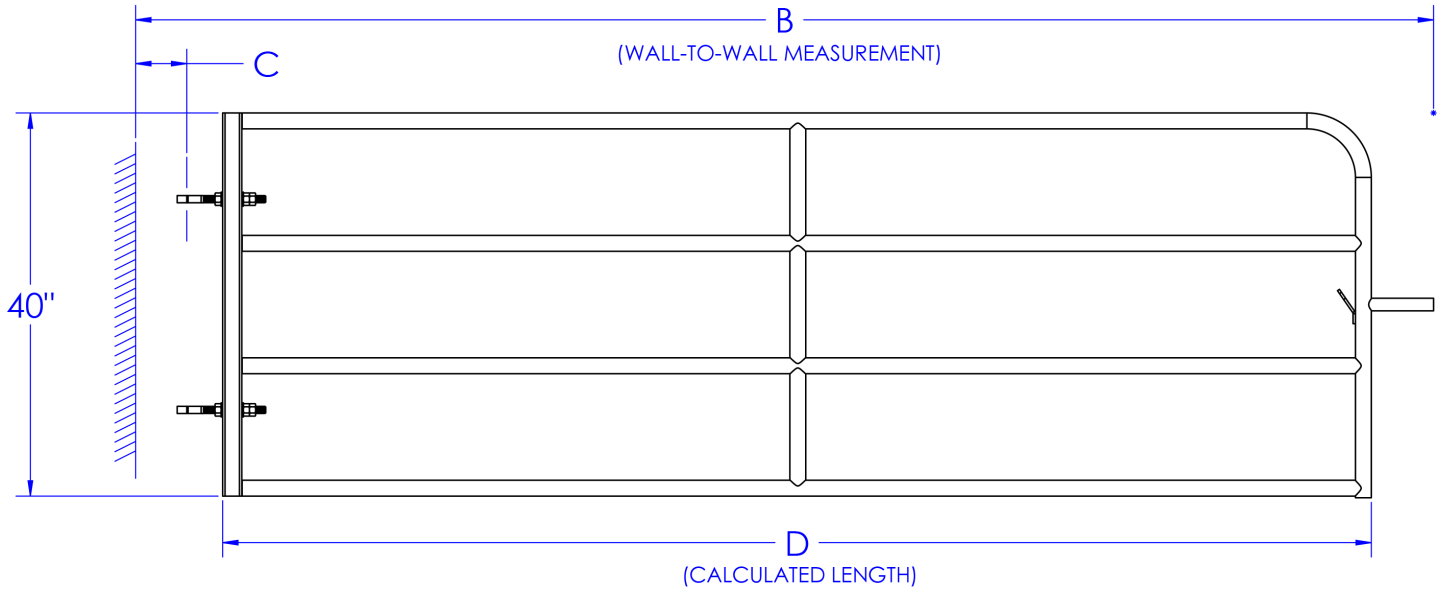

4 BAR HINGE BRACKETS				
PART #	DESCRIPTION	DIMENSIONS		
		C	F	G
53031 080	Hinge Bracket Weld-on	2.25	29.5	3
53031 080 EXTEN	Hinge Bracket Extended Weld-on	4.25	29.5	3
02500 4BG HB	Hinge Bracket Bolt-on	1.4375	34.25	3.75
02500 4BG HB EXTEN	Hinge Bracket Extended Bolt-on	3.4375	34.25	3.75

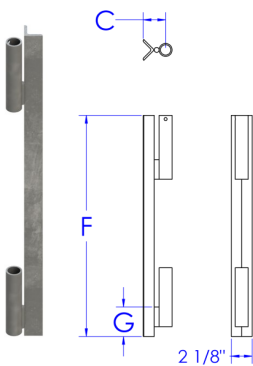
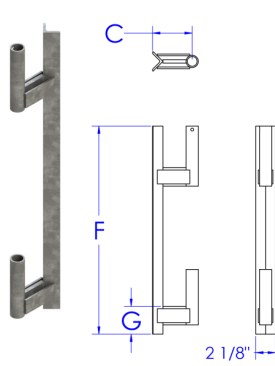
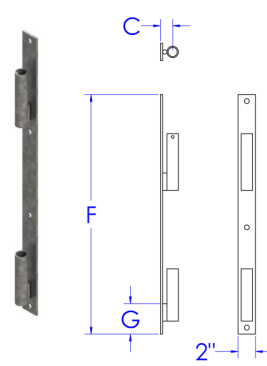
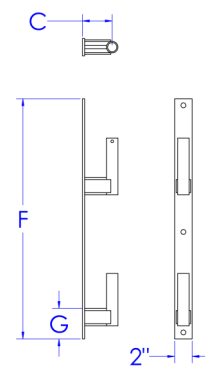
**53031 080**

**53031 080 EXTEN**

**02500 4BG HB**

**02500 4BG HB EXTEN**

# STABLING



## GATES - 4 BAR

<b>NO UPRIGHT CENTER POST</b>			
<b>LENGTH</b>	<b>PART #</b>	<b>A</b>	<b>B</b>
3'	02506 4BG 030	40	36
3'6"	02506 4BG 036	40	42
4'	02506 4BG 040	40	48
4'6"	02506 4BG 046	40	54
5'	02506 4BG 050	40	60
5'6"	02506 4BG 056	40	66
<b>1 UPRIGHT CENTER POST</b>			
6'	02506 4BG 060	40	72
6'6"	02506 4BG 066	40	78
7'	02506 4BG 070	40	84
7'6"	02506 4BG 076	40	90
8'	02506 4BG 080	40	96
8'6"	02506 4BG 086	40	102
9'	02506 4BG 090	40	108
9'6"	02506 4BG 096	40	114
10'	02506 4BG 100	40	120
10'6"	02506 4BG 106	40	126
11'	02506 4BG 110	40	132
11'6"	02506 4BG 116	40	138
12'	02506 4BG 120	40	144
12'6"	02506 4BG 126	40	150
13'	02506 4BG 130	40	156
13'6"	02506 4BG 136	40	162
14'	02506 4BG 140	40	168
14'6"	02506 4BG 146	40	174
<b>2 UPRIGHT CENTER POSTS</b>			
15'	02506 4BG 150	40	180
15'6"	02506 4BG 156	40	186
16'	02506 4BG 160	40	192
16'6"	02506 4BG 166	40	198

## GATES - 5 BAR

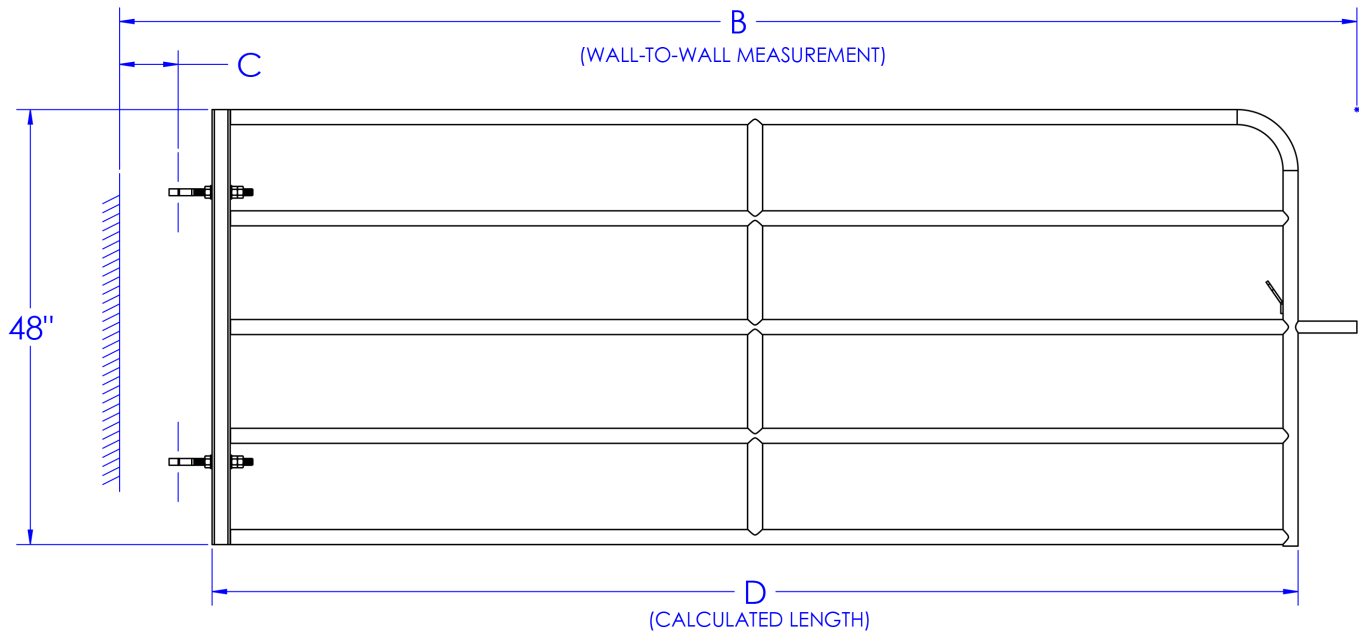

5 BAR HINGE BRACKETS				
PART #	DESCRIPTION	DIMENSIONS		
		C	F	G
53031 085	Hinge Bracket Weld-on	2.25	37.25	3
53031 085 EXTEN	Hinge Bracket Extended Weld-on	4.25	37.25	3
02500 5BG HB	Hinge Bracket Bolt-on	1.4375	42	3.75
02500 5BG HB EXTEN	Hinge Bracket Extended Bolt-on	3.4375	42	3.75

**53031 085**

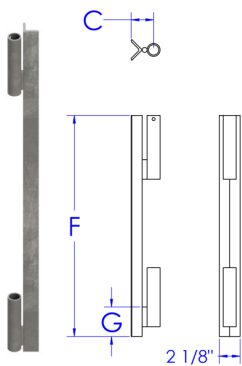

**53031 085 EXTEN**

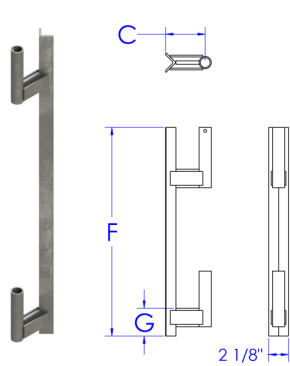

**02500 5BG HB**

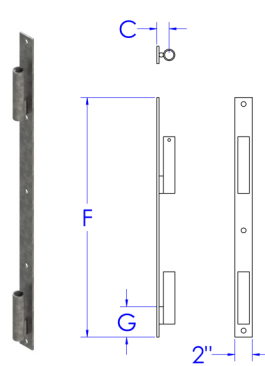

**02500 5BG HB EXTEN**

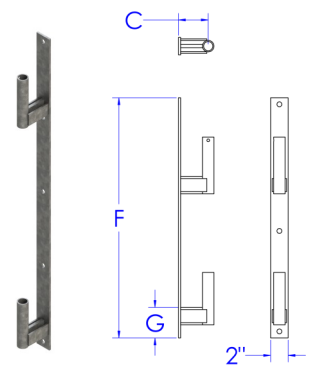

# STABLING



## GATES - 5 BAR

<b>NO UPRIGHT CENTER POST</b>			
<b>LENGTH</b>	<b>PART #</b>	<b>A</b>	<b>B</b>
3'	02506 5BG 030	48	36
3'6"	02506 5BG 036	48	42
4'	02506 5BG 040	48	48
4'6"	02506 5BG 046	48	54
5'	02506 5BG 050	48	60
5'6"	02506 5BG 056	48	66
<b>1 UPRIGHT CENTER POST</b>			
6'	02506 5BG 060	48	72
6'6"	02506 5BG 066	48	78
7'	02506 5BG 070	48	84
7'6"	02506 5BG 076	48	90
8'	02506 5BG 080	48	96
8'6"	02506 5BG 086	48	102
9'	02506 5BG 090	48	108
9'6"	02506 5BG 096	48	114
10'	02506 5BG 100	48	120
10'6"	02506 5BG 106	48	126
11'	02506 5BG 110	48	132
11'6"	02506 5BG 116	48	138
12'	02506 5BG 120	48	144
12'6"	02506 5BG 126	48	150
13'	02506 5BG 130	48	156
13'6"	02506 5BG 136	48	162
14'	02506 5BG 140	48	168
14'6"	02506 5BG 146	48	174
<b>2 UPRIGHT CENTER POSTS</b>			
15'	02506 5BG 150	48	180
15'6"	02506 5BG 156	48	186
16'	02506 5BG 160	48	192
16'6"	02506 5BG 166	48	198

## GATES - POSTS & MOUNTING ACCESSORIES

The items listed in this section are intended to be used for mounting the multi-bar gates. Typically these items are tubes with a clinched end to be set in the ground then cemented in place.

Items noted with "F.P." are tubes with a plate welded to one end. The plates have holes which allow for the post to be bolted the floor.

PART #	DESCRIPTION
02620 206 72	2 3/8" O.D. x .188 Wall x 72" Long - One End Clinched
02620 206 57 F.P.	2 3/8" O.D. x .188 Wall x 57 1/4" Long on 3/8" x 10" x 10" Floor Plate with 2 Gussets
02620 214 57 F.P.	2 7/8" O.D. x .188 Wall x 57 1/4" Long on 3/8" x 10" x 10" Floor Plate with 2 Gussets
02620 214 72 F.P. 5x5	2 7/8" O.D. x .203 Wall x 72" Long on 3/8" x 5" x 5" Floor Plate with 2 Gussets
02620 214 60 F.P.	2 7/8" O.D. x .188 Wall x 60" Long on 1/4" x 9 1/2" x 6" Floor Plate with 2 Gussets
02620 214 72	2 7/8" O.D. x .203 Wall x 72" Long - One End Clinched
02620 214 72 F.P.	2 3/8" O.D. x .188 Wall x 72" Long on 3/8" x 10" x 10" Floor Plate with 2 Gussets
02620 214 84	2 7/8" O.D. x .203 Wall x 84" Long - One End Clinched
02620 214 84 F.P. 5X5	2 7/8" O.D. x .203 Wall x 84" Long on 5" x 5" Floor Plate One End
02620 214 138	2 7/8" O.D. x .203 Wall x 138" Long - One End Clinched
02620 308 90	3 1/2" O.D. x .216 Wall x 90" Long - One End Clinched
02620 408 138	4 1/2" O.D. x .237 Wall x 138" Long - One End Clinched
02620 300.188 72 F.P.	3" x 3" x 3/16" Square Tube x 72" Long on 3/16" x 2" x 6 1/2" Floor Plate
02620 300.25 72 F.P.	3" x 3" x 1/4" Square Tube x 72" Long on 3/16" x 2" x 6 1/2" Floor Plate

### 02500 GSW

#### Gate Support Wheel

This assembly is manufactured long so that it is compatible with diverse gate sizes and floor depths. It may be trimmed to suit specific needs.

Mounting hardware is not included.

Mounting brackets/pipe clamps will vary depending on the gate tube size.  
 (Bauman gates use two 02611 025 clamps)

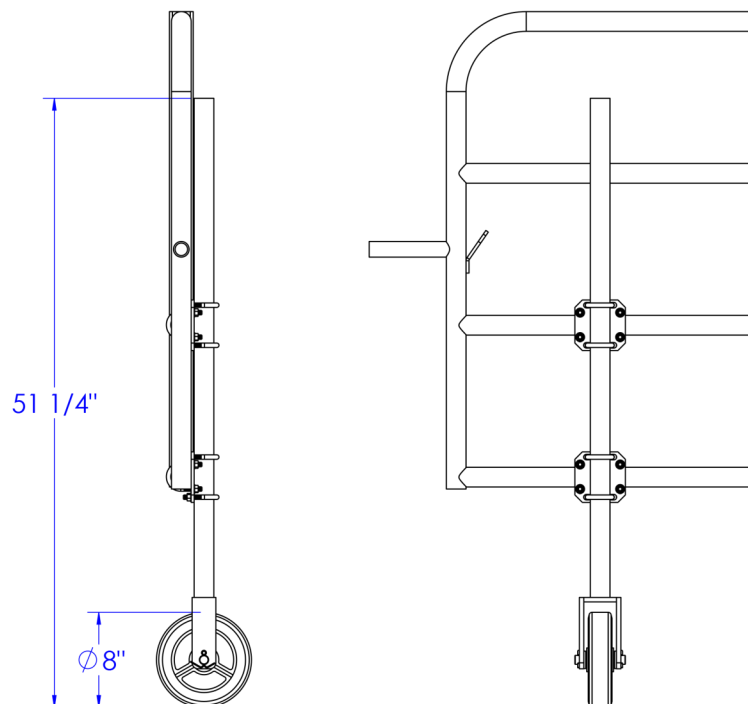

# STABLING



## GATE LATCHES

**02500 SPRING LATCH**



This latch is a spring actuated shaft which can be bolted/welded to any surface.

Clamps are also included to allow for installation onto a 1.66" O.D. tube.

**02500A T LATCH**

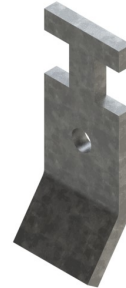

Small tee latch designed to be welded to any gate or post. A chain can be bolted to this latch via the center hole. T-notch grips the chain.

These are typically included on gate frame weldments.

**SLAM LATCHES** can be bolted or welded to any surface. Compatible with all multi-bar gates and/or gates with 1.315" O.D. locking stubs.

**02500S SLAM LATCH**



Easy close two way latch

**02500S SLAM LATCH I**

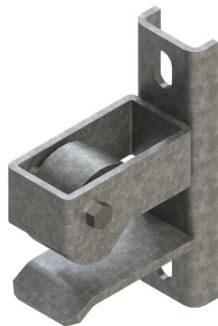

Easy close inline latch

**02500S SLAM LATCH R**

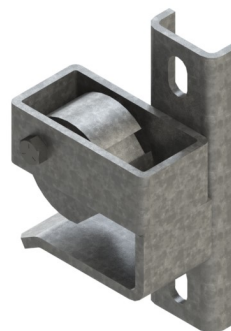

Easy close right gate, enter latch from the left

**02500S SLAM LATCH L**



Easy close left gate, enter latch from the right

## GATES

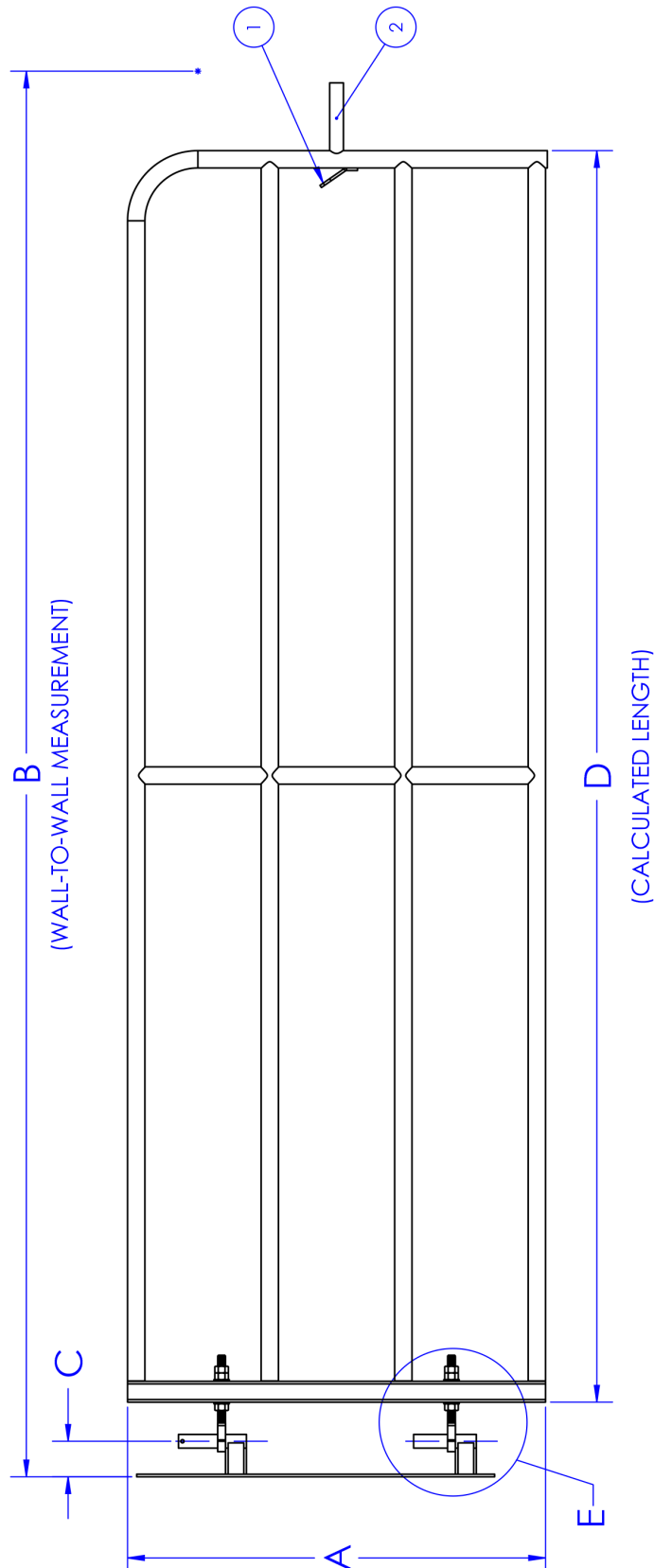



**MULTI-BAR GATE ORDER FORM**

**CUSTOMER:**

**P.O.#**

<b>GATE #</b>	<b>OPENING DIM. (Inches) (Dim. B)</b>	<b>GATE DIM. (Inches) (Dim. D)</b>	<b>GATE HEIGHT (Dim. A)</b>	<b>PIVOT POINT OFFSET FROM WALL (Dim. C)</b>	<b>LOCKING MECHANISM (Select 1 or more)</b>	<b>SLAM LATCH STYLE (Use only if 1" Pipe Stud was selected)</b>	<b>ADDITIONAL COMMENTS</b>
1			2-Bar (13.625")	Weld-on (2.25")	Spring Bar Bolt (02500 SPRING LATCH)	Slam Left (02500S SLAM LATCH L)	
			3-Bar (32")	Weld-on EXT (4.25")	T-Hook w/Chain (02500 T CHAIN LATCH)	Slam Right (02500S SLAM LATCH R)	
			4-Bar (40")	Bolt-on (1.4375")	1" Pipe Stub (Welded on Gate)	Slam 2-Way (02500S SLAM LATCH)	
			5-Bar (48")	Bolt-on EXT (3.4375")		Slam Inline (02500S SLAM LATCH I)	
			2-Bar (13.625")	Weld-on (2.25")	Spring Bar Bolt (02500 SPRING LATCH)	Slam Left (02500S SLAM LATCH L)	
2			3-Bar (32")	Weld-on EXT (4.25")	T-Hook w/Chain (02500 T CHAIN LATCH)	Slam Right (02500S SLAM LATCH R)	
			4-Bar (40")	Bolt-on (1.4375")	1" Pipe Stub (Welded on Gate)	Slam 2-Way (02500S SLAM LATCH)	
			5-Bar (48")	Bolt-on EXT (3.4375")		Slam Inline (02500S SLAM LATCH I)	
			2-Bar (13.625")	Weld-on (2.25")	Spring Bar Bolt (02500 SPRING LATCH)	Slam Left (02500S SLAM LATCH L)	
			3-Bar (32")	Weld-on EXT (4.25")	T-Hook w/Chain (02500 T CHAIN LATCH)	Slam Right (02500S SLAM LATCH R)	
3			4-Bar (40")	Bolt-on (1.4375")	1" Pipe Stub (Welded on Gate)	Slam 2-Way (02500S SLAM LATCH)	
			5-Bar (48")	Bolt-on EXT (3.4375")		Slam Inline (02500S SLAM LATCH I)	
			2-Bar (13.625")	Weld-on (2.25")	Spring Bar Bolt (02500 SPRING LATCH)	Slam Left (02500S SLAM LATCH L)	
			3-Bar (32")	Weld-on EXT (4.25")	T-Hook w/Chain (02500 T CHAIN LATCH)	Slam Right (02500S SLAM LATCH R)	
			4-Bar (40")	Bolt-on (1.4375")	1" Pipe Stub (Welded on Gate)	Slam 2-Way (02500S SLAM LATCH)	
4			5-Bar (48")	Bolt-on EXT (3.4375")		Slam Inline (02500S SLAM LATCH I)	
			2-Bar (13.625")	Weld-on (2.25")	Spring Bar Bolt (02500 SPRING LATCH)	Slam Left (02500S SLAM LATCH L)	
			3-Bar (32")	Weld-on EXT (4.25")	T-Hook w/Chain (02500 T CHAIN LATCH)	Slam Right (02500S SLAM LATCH R)	
			4-Bar (40")	Bolt-on (1.4375")	1" Pipe Stub (Welded on Gate)	Slam 2-Way (02500S SLAM LATCH)	
			5-Bar (48")	Bolt-on EXT (3.4375")		Slam Inline (02500S SLAM LATCH I)	
5			2-Bar (13.625")	Weld-on (2.25")	Spring Bar Bolt (02500 SPRING LATCH)	Slam Left (02500S SLAM LATCH L)	
			3-Bar (32")	Weld-on EXT (4.25")	T-Hook w/Chain (02500 T CHAIN LATCH)	Slam Right (02500S SLAM LATCH R)	
			4-Bar (40")	Bolt-on (1.4375")	1" Pipe Stub (Welded on Gate)	Slam 2-Way (02500S SLAM LATCH)	
			5-Bar (48")	Bolt-on EXT (3.4375")		Slam Inline (02500S SLAM LATCH I)	
			2-Bar (13.625")	Weld-on (2.25")	Spring Bar Bolt (02500 SPRING LATCH)	Slam Left (02500S SLAM LATCH L)	
6			3-Bar (32")	Weld-on EXT (4.25")	T-Hook w/Chain (02500 T CHAIN LATCH)	Slam Right (02500S SLAM LATCH R)	
			4-Bar (40")	Bolt-on (1.4375")	1" Pipe Stub (Welded on Gate)	Slam 2-Way (02500S SLAM LATCH)	
			5-Bar (48")	Bolt-on EXT (3.4375")		Slam Inline (02500S SLAM LATCH I)	
			2-Bar (13.625")	Weld-on (2.25")	Spring Bar Bolt (02500 SPRING LATCH)	Slam Left (02500S SLAM LATCH L)	
			3-Bar (32")	Weld-on EXT (4.25")	T-Hook w/Chain (02500 T CHAIN LATCH)	Slam Right (02500S SLAM LATCH R)	
7			4-Bar (40")	Bolt-on (1.4375")	1" Pipe Stub (Welded on Gate)	Slam 2-Way (02500S SLAM LATCH)	
			5-Bar (48")	Bolt-on EXT (3.4375")		Slam Inline (02500S SLAM LATCH I)	
			2-Bar (13.625")	Weld-on (2.25")	Spring Bar Bolt (02500 SPRING LATCH)	Slam Left (02500S SLAM LATCH L)	
			3-Bar (32")	Weld-on EXT (4.25")	T-Hook w/Chain (02500 T CHAIN LATCH)	Slam Right (02500S SLAM LATCH R)	
			4-Bar (40")	Bolt-on (1.4375")	1" Pipe Stub (Welded on Gate)	Slam 2-Way (02500S SLAM LATCH)	
8			5-Bar (48")	Bolt-on EXT (3.4375")		Slam Inline (02500S SLAM LATCH I)	
			2-Bar (13.625")	Weld-on (2.25")	Spring Bar Bolt (02500 SPRING LATCH)	Slam Left (02500S SLAM LATCH L)	
			3-Bar (32")	Weld-on EXT (4.25")	T-Hook w/Chain (02500 T CHAIN LATCH)	Slam Right (02500S SLAM LATCH R)	
			4-Bar (40")	Bolt-on (1.4375")	1" Pipe Stub (Welded on Gate)	Slam 2-Way (02500S SLAM LATCH)	
			5-Bar (48")	Bolt-on EXT (3.4375")		Slam Inline (02500S SLAM LATCH I)	

## SLANT BAR

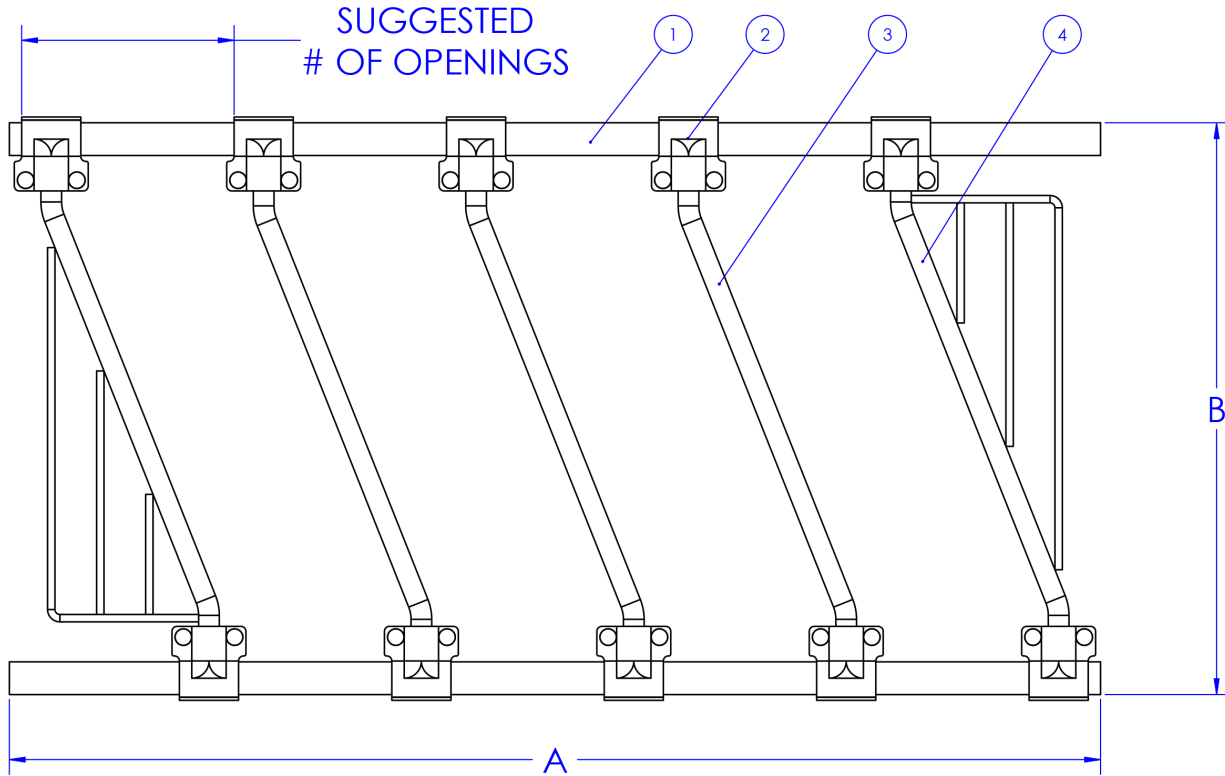

CALVES - 2-6 months old						
PART #	COMPONENTS	ITEM COUNT	DESCRIPTION	A (FEET)	B (INCHES)	SUGGESTED # OPENINGS
02621-04-8	(1) 02002 104**	2	1 1/4" Galvanized Pipe	8	29	9
	(2) 3001053110	20	Clamps			
	(3) 02621 012	8	Slant Bar			
	(4) 02621 012 F.B.	2	End Slant Bar			
02621-04-10	(1) 02002 104**	2	1 1/4" Galvanized Pipe	10	29	10
	(2) 3001053110	22	Clamps			
	(3) 02621 012	9	Slant Bar			
	(4) 02621 012 F.B.	2	End Slant Bar			
02621-04-12	(1) 02002 104**	2	1 1/4" Galvanized Pipe	12	29	11
	(2) 3001053110	24	Clamps			
	(3) 02621 012	10	Slant Bar			
	(4) 02621 012 F.B.	2	End Slant Bar			

# STABLING



## SLANT BAR

All slant bar assemblies consist of two horizontal tubes of length “A”, spaced apart via a series of slant bars.. The slant bars are clamped in place along the tube length such that their position may be adjusted at any time. Slant bars may be removed from a given configuration to allow for more head space.

Example: As a group of young animals grow, a slant bar could be removed from the 0261-08-10 Young Stock assembly and re-spaced along the tubes. The stalls are now spaced further apart and can accommodate a larger animal.

For reference, the contents of each assembly has been indicated in the table provided.

**Custom slant bar lengths “A” are available upon request.**

YOUNG STOCK - 6-8 months old						
PART #	COMPONENTS	ITEM COUNT	DESCRIPTION	A (FEET)	B (INCHES)	SUGGESTED # OPENINGS
02621-06-8	(1) 02002 104**	2	1 ¼” Galvanized Pipe	8	40	6
	(2) 3001053110	14	Clamps			
	(3) 02621 012-36.5	5	Slant Bar			
	(4) 02621 012 F.B.-36.5	2	End Slant Bar			
02621-06-10	(1) 02002 104**	2	1 ¼” Galvanized Pipe	10	40	8
	(2) 3001053110	18	Clamps			
	(3) 02621 012-36.5	7	Slant Bar			
	(4) 02621 012 F.B.-36.5	2	End Slant Bar			
02621-06-12	(1) 02002 104**	2	1 ¼” Galvanized Pipe	12	40	10
	(2) 3001053110	22	Clamps			
	(3) 02621 012-36.5-36.5	9	Slant Bar			
	(4) 02621 012 F.B.	2	End Slant Bar			

HEIFER - 8-10 months old						
PART #	COMPONENTS	ITEM COUNT	DESCRIPTION	A (FEET)	B (INCHES)	SUGGESTED # OPENINGS
02621-08-8	(1) 02002 104**	2	1 ¼” Galvanized Pipe	8	40	5
	(2) 101110E	12	Clamps			
	(3) 02621 104	4	Slant Bar			
	(4) 02621 104 F.B.	2	End Slant Bar			
02621-08-10	(1) 02002 104**	2	1 ¼” Galvanized Pipe	10	40	7
	(2) 101110E	16	Clamps			
	(3) 02621 104	6	Slant Bar			
	(4) 02621 104 F.B.	2	End Slant Bar			
02621-08-12	(1) 02002 200**	2	2” Galvanized Pipe	12	40	9
	(2) 3001075110	20	Clamps			
	(3) 02621 104	8	Slant Bar			
	(4) 02621 104 F.B.	2	End Slant Bar			

## SLANT BAR

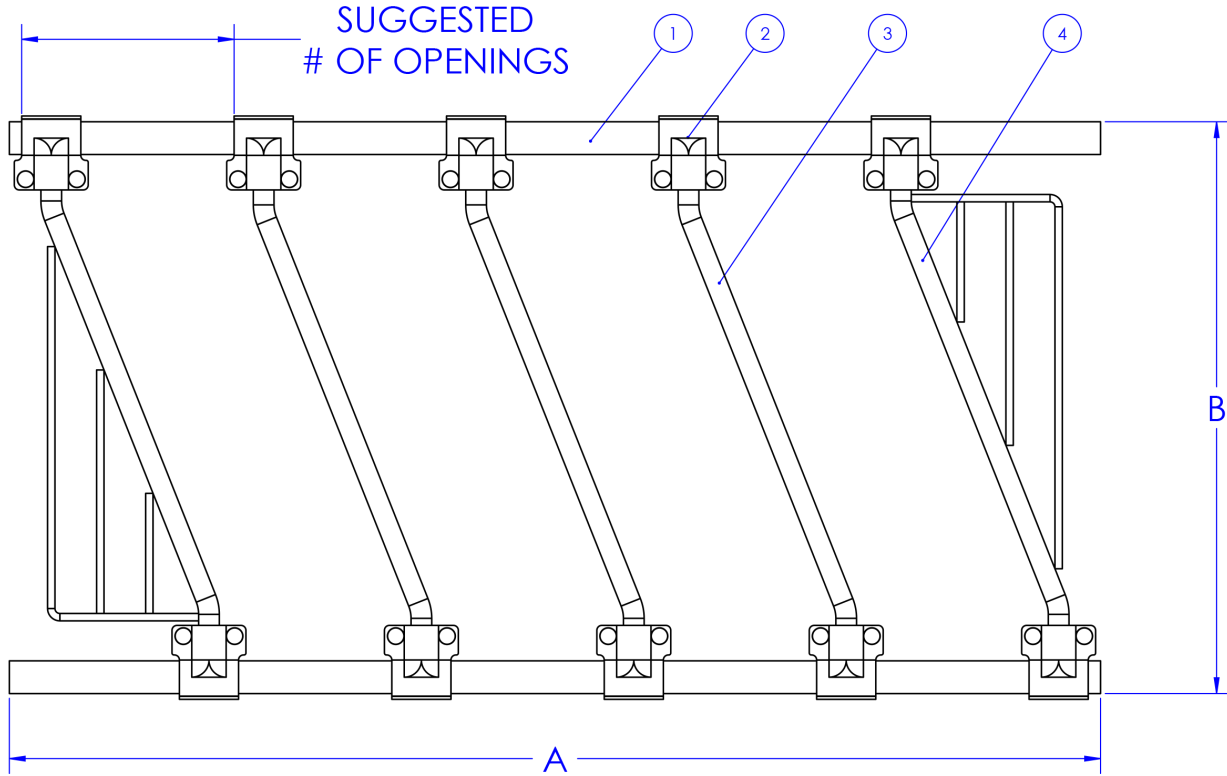

LARGE ANIMALS - 10-12 months old						
PART #	COMPONENTS	ITEM COUNT	DESCRIPTION	A (FEET)	B (INCHES)	SUGGESTED # OPENINGS
02621-10-8	(1) 02002 104**	2	1 1/4" Galvanized Pipe	8	40	4
	(2) 101110E	10	Clamps			
	(3) 02621 104	3	Slant Bar			
	(4) 02621 104 F.B.	2	End Slant Bar			
02621-10-10	(1) 02002 104**	2	1 1/4" Galvanized Pipe	10	40	6
	(2) 101110E	14	Clamps			
	(3) 02621 104	5	Slant Bar			
	(4) 02621 104 F.B.	2	End Slant Bar			
02621-10-12	(1) 02002 200**	2	2" Galvanized Pipe	12	40	7
	(2) 3001075110	16	Clamps			
	(3) 02621 104	6	Slant Bar			
	(4) 02621 104 F.B.	2	End Slant Bar			

# STABLING



## SLANT BAR

LARGE HEAD OPENING - 12 + months old						
PART #	COMPONENTS	ITEM COUNT	DESCRIPTION	A (FEET)	B (INCHES)	SUGGESTED # OPENINGS
02621-12-8	(1) 02002 104**	2	1 ¼" Galvanized Pipe	8	40	4
	(2) 101110E	10	Clamps			
	(3) 02621 104	3	Slant Bar			
	(4) 02621 104 F.B.	2	End Slant Bar			
02621-12-10	(1) 02002 104**	2	1 ¼" Galvanized Pipe	10	40	5
	(2) 101110E	12	Clamps			
	(3) 02621 104	4	Slant Bar			
	(4) 02621 104 F.B.	2	End Slant Bar			



**02616 002**

The **Manger Post** stands 60" tall and consists of a sheet metal plate formed into a channel, with a short metal strip along the base. The post is to be positioned and then cemented in place.

Two sets of slotted holes along the channel allow this post to be used as either an end post or mid-way bridge between two self-lock or slant bar fronts.

Brackets such as 02616 001 and 02616 003 can be installed onto this post to allow for the mounting of a head rail.

**02619 210**



**02619 210-4**



These brackets come with a pair of U-bolts which are used to fasten them to a vertical post. When mounted on a post, the two remaining slotted holes along the bracket allow this assembly to be used as either an end post or mid-way bridge between two self-lock or slant bar fronts.

### Sheet Metal Clamps

These clamps perpendicularly link the end of one tube, to the length of another.

**101110E**



**3001053110** \*shown  
**3001075110**



**101120G**



## MANGER FRONT - CALF SELF-LOCK - ADJUSTABLE OPENING

This family of stabling front gates consist of a series of pivoting bars which automatically lock once the bar becomes vertical. When in the locked position, animals are unable to free their head from the gate, allowing the animal to be examined or worked on.

The top metal shaft may be rotated 180 degrees via a handle, simultaneously releasing any auto-locked stalls.

Individual cells may be manually locked using a pin (02619 152), thus preventing animal release when the locking bar has been rotated to the "unlocked" position.

This series of self-lock fronts have rigid vertical bars installed every 18" apart. There are also adjustable bars which are clamped in place and can be slid to desired spacing, depending on the age/size of the animal.

The image referencing the assembly displays the self-lock bars in the unlocked position, with pins holding the pivoting bar in place (right side of image).

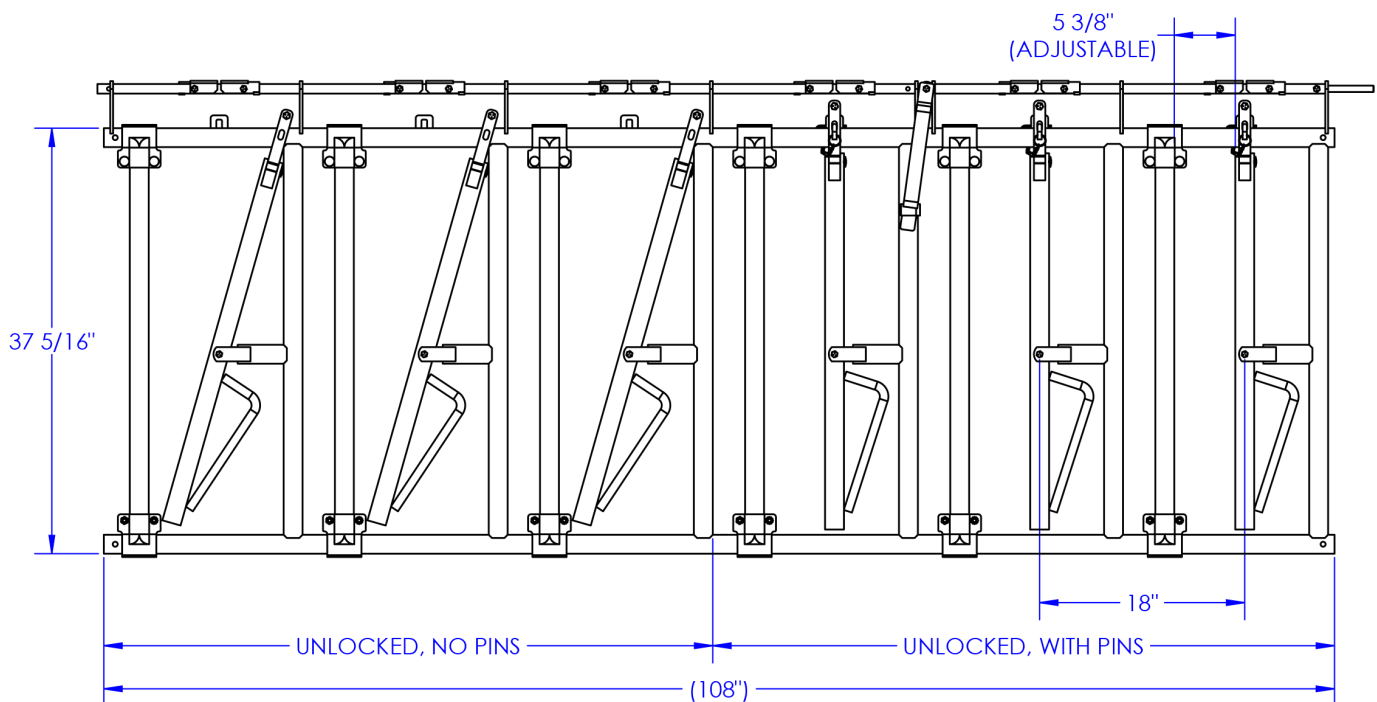

CALF SELF-LOCK—ADJUSTABLE OPENING			
PART #	DESCRIPTION	OPENINGS	LENGTH
02617 100 09-18	Calf Self Lock Manger Front –18"	6 Calf	9 FT. SECTION
02617 100 10.5-18	Calf Self Lock Manger Front –18"	7 Calf	10.5 FT. SECTION
02617 100 12-18	Calf Self Lock Manger Front –18"	8 Calf	12 FT. SECTION

# STABLING



## MANGER FRONT - HEIFER SELF-LOCK - ADJUSTABLE OPENING

The self-lock stall family is manufactured to custom lengths to meet the unique requirements of a given floor layout.

This series of self-lock fronts are much like the calf self-lock, but are a little taller and have rigid vertical bars installed every 23.5" apart. There are also adjustable bars which are clamped in place and can be slid to desired spacings, depending on the age/size of the animal.

The image referencing this assembly displays the self-lock bars in the unlocked position, with pins holding the pivoting bar in place (right side of image).

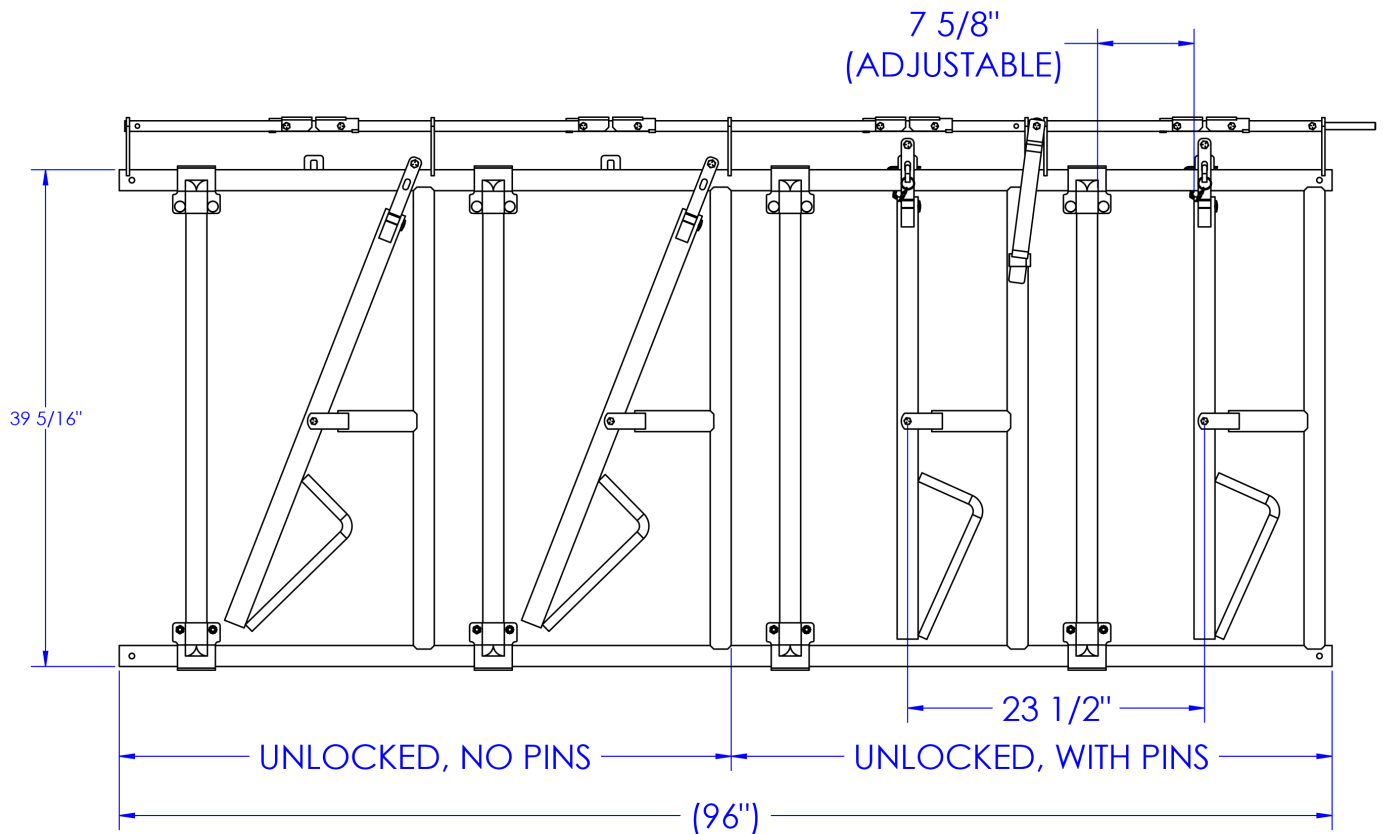

HEIFER SELF-LOCK—ADJUSTABLE OPENING			
PART #	DESCRIPTION	OPENINGS	LENGTH
02617 100 08-24	Self Lock Manger Front—24"	4 Cattle	8 FT. SECTION
02617 100 10-24	Self Lock Manger Front—24"	5 Cattle	10 FT. SECTION
02617 100 12-24	Self Lock Manger Front—24"	6 Cattle	12 FT. SECTION

## MANGER FRONT - LARGE CATTLE 24" SELF-LOCK

This series of self-lock fronts are a little different from the smaller animal versions, such that they do not have sliding adjustable neck openings.

The difference between adjustable and non-adjustable versions is the adjustable version comes with a spring loaded post which fits into one of three locations. The non-adjustable version simply has a post welded in place.

24" WIDE FEED STATION (UNLOCKED ORIENTATION)  
 LEFT MOST STALL PINNED IN PLACE.

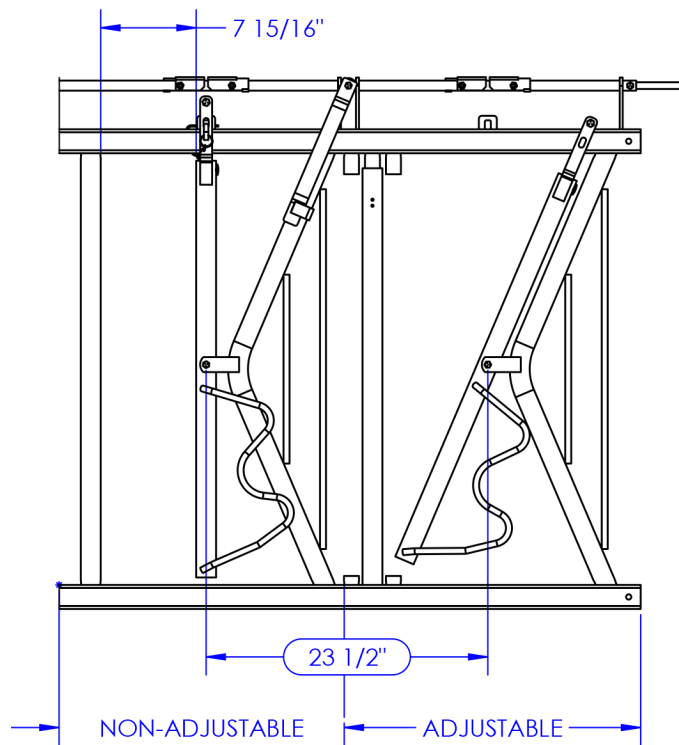

LARGE CATTLE 24"/ANIMAL SELF-LOCK—ADJUSTABLE OPENING			
PART #	DESCRIPTION	OPENINGS	LENGTH
02619 08-24	Self Lock Manger Front –24"	4 Cattle	8 FT. SECTION
02619 10-24	Self Lock Manger Front –24"	5 Cattle	10 FT. SECTION
02619 12-24	Self Lock Manger Front –24"	6 Cattle	12 FT. SECTION

LARGE CATTLE 24"/ANIMAL SELF-LOCK—NON-ADJUSTABLE OPENING			
PART #	DESCRIPTION	OPENINGS	LENGTH
02619 08-24 NON AD	Self Lock Manger Front –24"	4 Cattle	8 FT. SECTION
02619 10-24 NON AD	Self Lock Manger Front –24"	5 Cattle	10 FT. SECTION
02619 12-24 NON AD	Self Lock Manger Front –24"	6 Cattle	12 FT. SECTION



# STABLING



## MANGER FRONT - LARGE CATTLE 28" SELF-LOCK

Both 23 1/2" and 28", adjustable and non-adjustable versions, have a nominal locked opening of ~8".

The rightmost image references this series in the unlocked position, with one post pinned in place. The leftmost image displays the self-lock in the locked position, no pins required.

28" WIDE FEED STATION (LOCKED ORIENTATION)

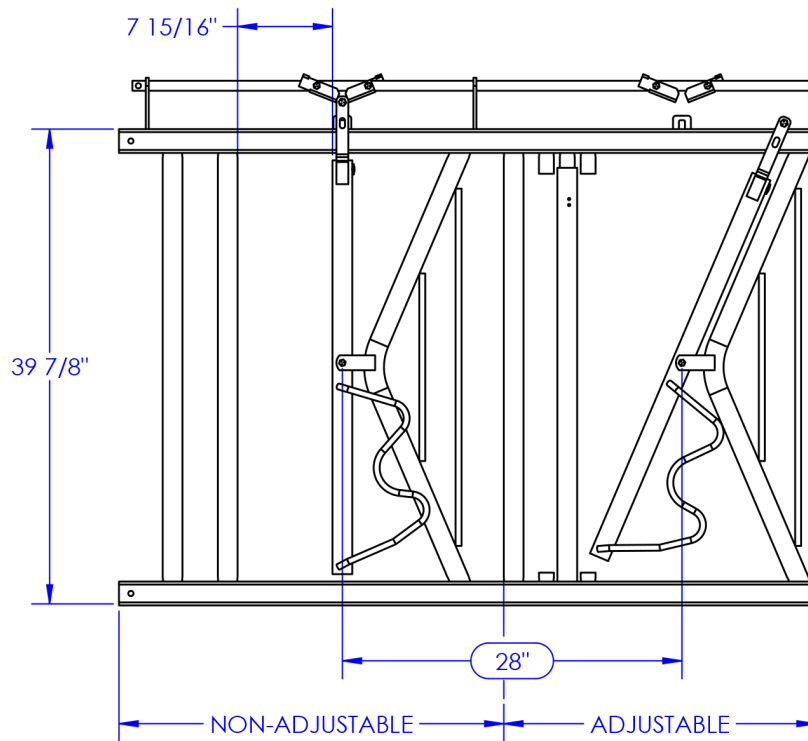

LARGE CATTLE 28"/ANIMAL SELF-LOCK—ADJUSTABLE OPENING			
PART #	DESCRIPTION	OPENINGS	LENGTH
02619 08-28	Self Lock Manger Front –28"	3 Cattle	8 FT. SECTION
02619 10-28	Self Lock Manger Front –28"	4 Cattle	10 FT. SECTION
02619 12-28	Self Lock Manger Front –28"	5 Cattle	12 FT. SECTION

LARGE CATTLE 28"/ANIMAL SELF-LOCK—NON-ADJUSTABLE OPENING			
PART #	DESCRIPTION	OPENINGS	LENGTH
02619 08-28 NON AD	Self Lock Manger Front –28"	3 Cattle	8 FT. SECTION
02619 10-28 NON AD	Self Lock Manger Front –28"	4 Cattle	10 FT. SECTION
02619 12-28 NON AD	Self Lock Manger Front –28"	5 Cattle	12 FT. SECTION

## SELF-LOCK - PARTS COMMON TO ALL SIZES

02619 120



### Flat Bar Locking Handle

Each self-lock assembly includes one of these handles. Depending on the length of the self-lock front and if multiple self-lock fronts have been split up or coupled together, additional handles may be desired for convenience.

02619 152



### Self-lock Locking Pin

The pin is used to manually lock an individual self-lock cell. Typically one pin is included with a given self-lock assembly. Any additional pins required should be purchased separately.

02619 165



### Joiner for Locking Bar

The locking bar for each self-lock assembly is a tube with open ends. If two self-locking assemblies are to be positioned beside each other, the locking bars can be coupled together using this pin and some hardware. Additional holes may need to be drilled in the locking bar and/or the pin before the components can be bolted together.

02619 210



These brackets come with a pair of U-bolts which are used to fasten it to a vertical round post. When mounted on a post, the two remaining slotted holes along the bracket allow this assembly to be used as either an end post or mid-way bridge between two self-lock or slant bar fronts.

02619 210-4



# STABLING



## MANGER RAIL ACCESSORIES

02616 001



### 2" Pipe Bolt-on Rail Bracket

This component gets fixed to the slotted holes of 02616 002 manger post, and is used to support a 2" diameter pipe (head rail).

The image is shown upside-down with respect to how it is installed.

02616 003



**2" Adjustable Rail Bracket** with Clamping Plate functions much the same as 02616 001, however the mounting location of this version can be adjusted. This component slides over 02616 002 manger post, with the clamping plate on the inside of the channel. When the bracket has been positioned at the desired location, the bolts are tightened, clamping the bracket to the post.

02616 004

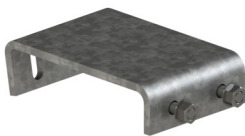

### Self-Lock Manger Front Tilt Bracket

Mount one of these brackets at the top of each end post for a given manger and fasten the manger front to the opposite end of this bracket. The assembled manger front will now be tilted 6" out at the top.

02611 015 (for 1 1/4" galvanized pipe)

02611 017 (for 2" galvanized pipe)



### Pipe Joiners

6" joiners co-axially link two of the same size tubes together.

The joiner is positioned inside the coupled tubes.

02616 002



This manger post stands 60" tall and consists of a sheet metal plate formed into a channel, with a short metal strip along the base. Post is to be positioned and then cemented in place.

Two sets of slotted holes along the channel allow this post to be used as either an end post or mid-way bridge between two self-lock or slant bar fronts.

Brackets such as 02616 001 and 02616 003 can be installed onto this post to allow for the mounting of a head rail.

02002 200\*\*

### 2" Galvanized Pipe, 24 feet long.

Pipe acts as a head rail for manger applications. The rail can be cut to length as needed, and is mounted using a compatible bracket such as 02616 001 or 02616 003 and joined together with 02611 017.

02611 016 (for 1 1/4" galvanized pipe)

02611 018 (for 2" galvanized pipe)

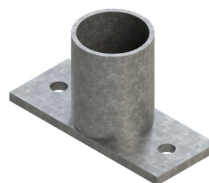

### Wall Brackets

Brackets consist of a tube welded to a plate which can be bolted or welded in place. The wall bracket tube goes inside the long tube.

## CALF PENS - PLASTIC PEN FRONTS

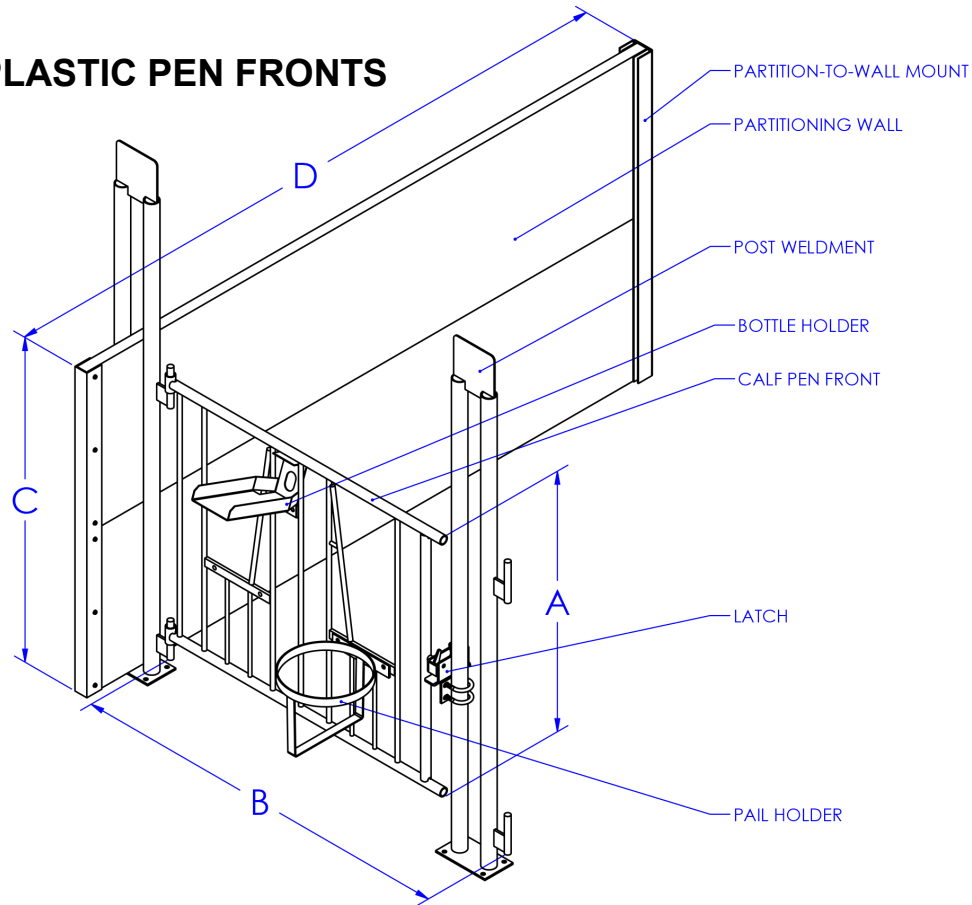

### PLASTIC PARTITION PEN FRONT

PART #	DESCRIPTION	A	B
02605 120-36	Pen Front for 36" Wide Pen – 2 Openings	32"	36"
02605 120-42	Pen Front for 42" Wide Pen – 2 Openings	32"	42"
02605 120-48	Pen Front for 48" Wide Pen – 2 Openings	32"	48"
02605 120-60	Pen Front for 60" Wide Pen – 2 Openings	32"	60"



NOTE: Partitions are typically longer than the desired pen length. This additional material is to prevent calves from reaching around the front of the stall, to the adjacent stall.

### PLASTIC PARTITION

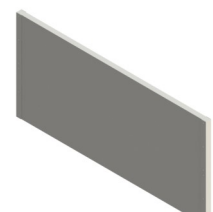
 NOTE: Partitions are white	PART #	DESCRIPTION	C	D
	02605 140 40x72	Plastic Pen Partition 40" High x 60" Long	40"	72"
	02605 140 40x80	Plastic Pen Partition 40" High x 72" Long	40"	80"
	02605 140 40x96	Plastic Pen Partition 40" High x 84" Long	40"	96"
	02605 140 40x108	Plastic Pen Partition 40" High x 96" Long	40"	108"
	02605 140 48x96	Plastic Pen Partition 48" High x 84" Long	48"	96"

# STABLING



## CALF PENS - SPINDLE PEN FRONTS

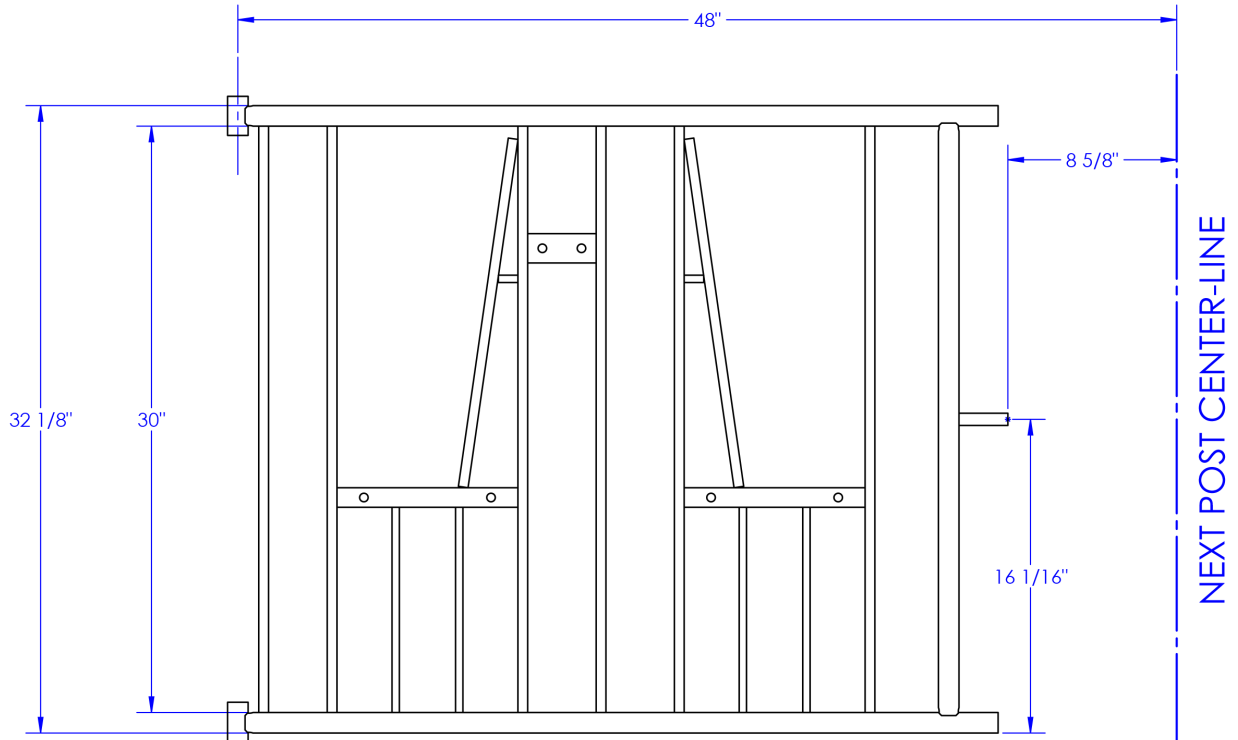

NOTE: The main difference between a **Plastic** partition pen front and a **Spindle** partition pen front are the post weldments surrounding the front wall.

SPINDLE PEN FRONT			
PART #	DESCRIPTION	A	B
02607 120-36 FRONT	Pen Front for 36" Wide Pen – 2 Openings	32"	36"
02607 120-42 FRONT	Pen Front for 42" Wide Pen – 2 Openings	32"	42"
02607 120-48 FRONT	Pen Front for 48" Wide Pen – 2 Openings	32"	48"

SPINDLE PARTITION		
PART #	DESCRIPTION	
02607 110-32 PEN PARTITION	Spindle pen partition 3/8" Rods, 32" long, spaced 3" apart (C-to-C) 1.315" O.D. pipe top & bottom.	

## CALF PENS - POSTS

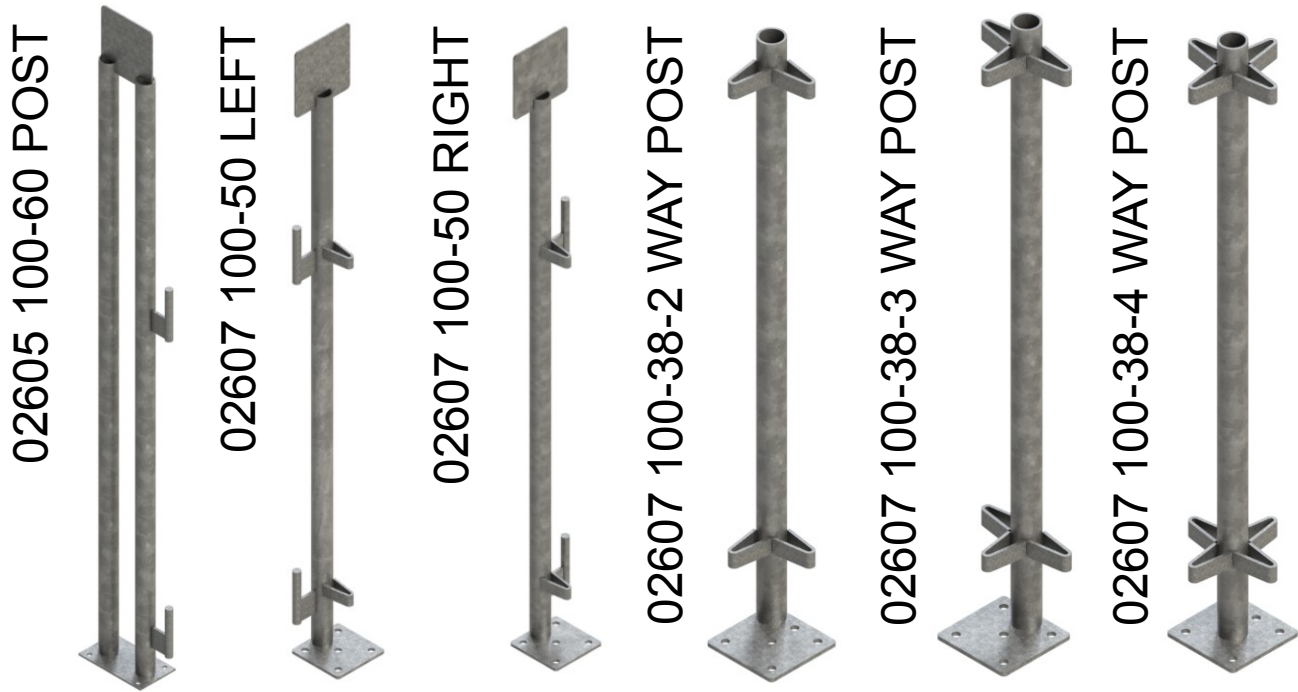

PLASTIC PEN POSTS	
PART #	DESCRIPTION
02605 100-50	Double Post 50" High, on Floor Plate for Plastic Plank Pen Partition
02607 100-60	Double Post 60" High, on Floor Plate for Plastic Plank Pen Partition
02607 100-70	Double Post 70" High, on Floor Plate for Plastic Plank Pen Partition

### 02605 180CHA

Wall mount channel  
for plastic pen partition



SPINDLE PEN POSTS	
PART #	DESCRIPTION
02607 100-50 LEFT	Gate Post with Hinge Hook Left and One-way Panel Loop
02607 100-50 RIGHT	Gate Post with Hinge Hook Right and One-way Panel Loop
02607 100-38-2 WAY POST	Panel Post comes with Post Loops for Two Ways
02607 100-38-3 WAY POST	Panel Post comes with Post Loops for Three Ways
02607 100-38-4 WAY POST	Panel Post comes with Post Loops for Four Ways

# STABLING



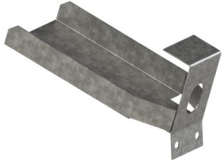

## CALF PENS - ACCESSORIES

BOTTLE HOLDERS	
PART #	DESCRIPTION
02605 150	2 Litre Bottle Holder with Nuts & Bolts (Bottle Not Included)
02605 160	3 Litre Bottle Holder with Nuts & Bolts (Bottle Not Included)



PAIL HOLDERS	
PART #	DESCRIPTION
02605 0003	Single Pail Holder with Bottom Support for a 10" Diameter Pail
02605 0004	Double Pail Holder with Bottom Support for a 10" Diameter Pail

### 02605 125

#### FLIPPER LATCH

Dual direction, auto-locking gate latch that is designed to U-bolt onto 1-1/4" pipe. For calf pen fronts.

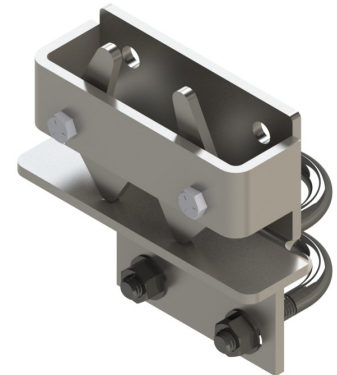

### 02605 170HB

Wall mount hinge bracket.



### 02607 100-32 WALL BRACKET

Wall bracket comes with loops to support one end of a spindle partition. Used in conjunction with part #02607 110-37 DROP PIN to hold the components together.



### 02605 110

Pen partition pin with hair pin for plastic plank pen partition.



### 02607 110-37 DROP PIN

Drop pin for spindle with 3/2" Rod. 2 pins per panel.



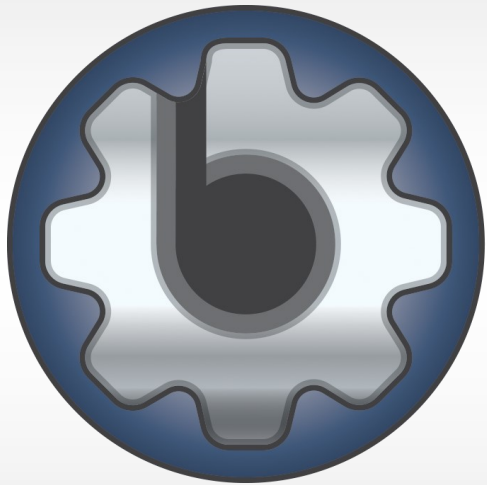

# **BAUMAN MANUFACTURING**

BACKED BY A TRADITION OF QUALITY

[www.baumanmfg.com](http://www.baumanmfg.com)